

Stand on the ground, FUJISJ elevator

Smooth

Quiet

Safe



AUTHORISED PARTNER



FUJI ELEVATOR CO.,LTD

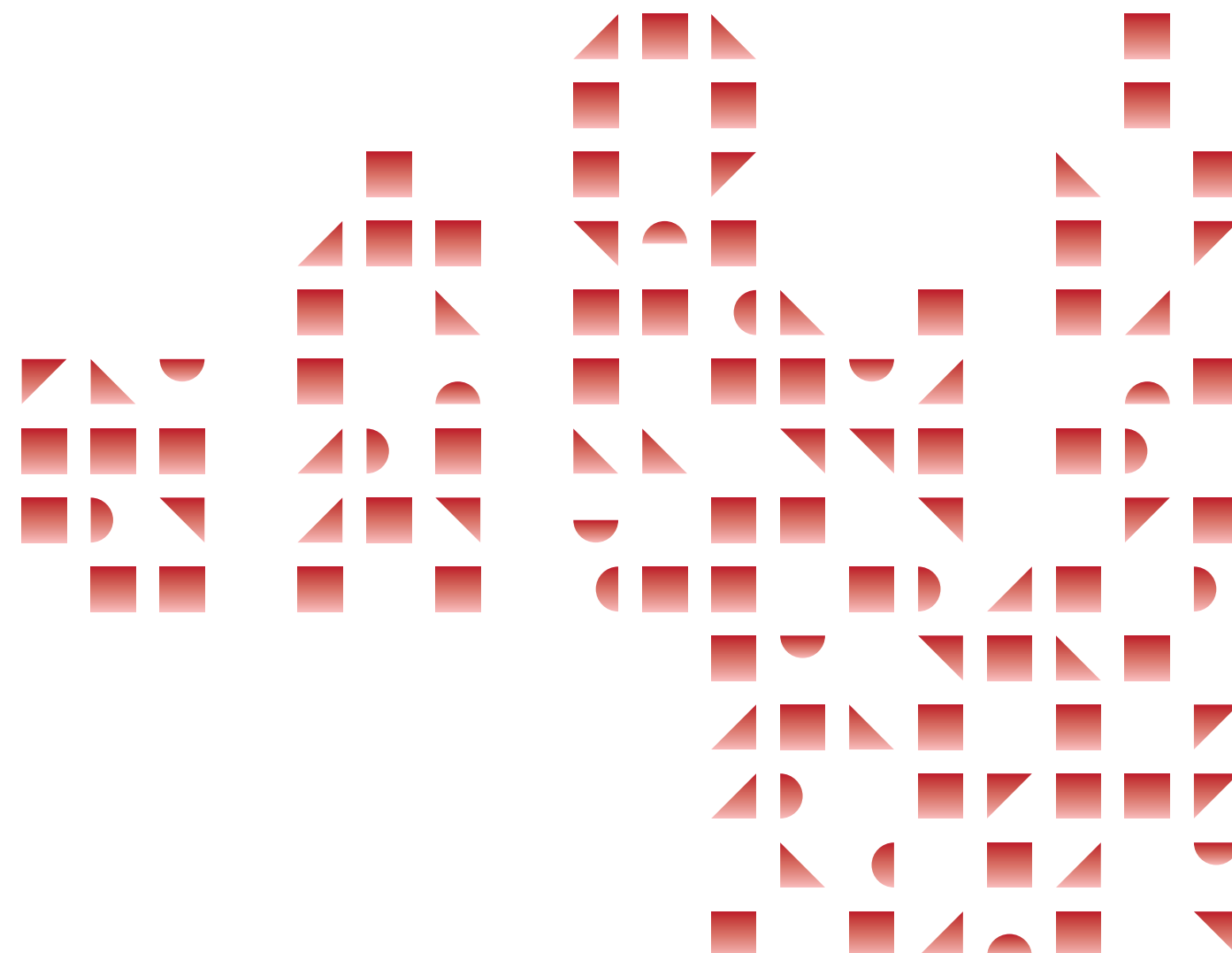

Company profile

Fuji Elevator has over 40-years History of elevator manufacturing , And It is the only national R&D and manufacturing base of Japan Fuji mechanical and electrical.





Distributor Authorization Letter 经销商授权书

We hereby authorize 360 ROYAL TECHNICAL SERVICES CONTRACTING LLC as our distributor in UAE to sell and maintain our products within the authorized territory. Under the premise of not violating the law, regulations and company rules and regulations, develop the market and continue to increase the market share of FUJISJ elevator products in this area.

兹授权 360 ROYAL TECHNICAL SERVICES CONTRACTING LLC 为我在 阿联酋 的经销商，在指定区域销售并维保我司的产品。在不违反法律、规定和公司规章制度的前提下开拓市场，持续提高 FUJISJ 电梯产品在该区域的市场份额。

distributor Territory : Territory in UAE only

销售区域：销售地区只限在 阿联酋 销售。

Authorization time: 01/08/2022-31/07/2023

授权期限：01/08/2022-31/07/2023

The above mentioned agent has no right to transfer the authorization.
上述授权经销商无权转让委托，特此声明。

Company name: FUJI ELEVATOR CO., LTD.

授权单位名称 (盖章) 富士电梯有限公司

签发日期: Issue Date: 01/08/2022

www.fujisj.com

About programming

FUJISJ feltless elevator is the world first to change the program design from traditional input type to adaptive data dictionary. The "big and small steps" in the previous speed control curve are finely ground into an extremely smooth "ice surface" that has no feeling of acceleration and deceleration.

The fusion of the perception technology and AI intelligence

FUJISJ feltless elevator adopts the fusion application of advanced real-time accurate load sensing technology and AI intelligent algorithm to realize the stepless weighing torque compensation and automatic adjustment of starting parameters, and truly made it start

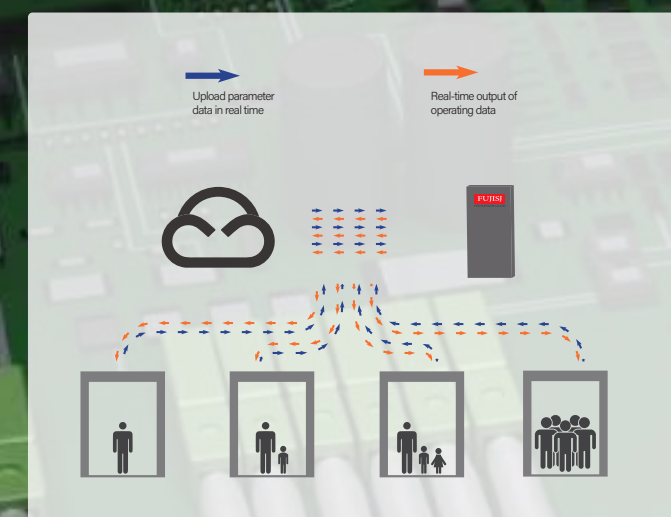

Mechanical structure design

FUJISJ feltless elevator has undergone tens of thousands of combined gravity compression + buffering experimental parameter tests, and obtained the optimal elastic coefficient fusion damping scheme required by each damping unit under different ladder structures, different speeds and load conditions, and perfectly The three are tested and matched, which comprehensively solves all the discomfort caused by the mechanical vibration of the elevator, making the running without feeling.

1.Six-year warranty on three major parts

- ① Six-year warranty scope:
Traction machine, Integrated control cabinet,Door operator.
- ② Warranty conditions:

The parts within the above range are guaranteed for six years under normal use environment and conditions. For damage caused by force majeure or improper use, management, and maintenance, the parts will be charged at the cost price.

2.Five years free replacement for consuming parts

Global brand FUJI Elevator, surpassing the industry rules, provides free elevator consuming parts for five years.



“stand on the ground,FUJISI elevator - quiet,smooth,safe”

Fuji elevator Co.,Ltd

FUJI ELEVATOR CO. , LTD

富吉电梯有限公司

富吉电梯【2021】第 3 号

为进一步彰显富吉电梯与日本富士机电在电梯生产领域的强大技术实力,为用户提供高品质的产品与服务,实现电梯全生命周期价值最大化,富吉电梯重磅推出超长质保政策,具体内容如下:

电梯核心三大件免费质保 6 年

1. 曳引机 (不包括曳引轮)

2. 控制柜 (一体机)

3. 门机 (门电机和门控器)

In order to further demonstrate the strong technical strength of Fuji Elevator and Fuji Electric in the field of elevator production and R&D, provide users with high-quality products and services, maximize the value of the elevator life cycle, Fuji Elevator has launched sales policy to benefit customer. The specific contents include:

Six-year free warranty for the three major parts of the elevator

1. Traction machine(except for pulley)

2. Control cabinet(integrate machine)

3. Door operator(door inverter and motor)

Subject terms: Fuji elevator, free warranty

Issued: Fuji Elevator sales staff and agents worldwide

28th Sep 2021 print

Total 1 copy



FUJI Elevator Co.,LTD

28th Sep 2021



“stand on the ground,FUJISI elevator - quiet,smooth,safe”

Fuji elevator Co.,Ltd

FUJISI Elevator Consuming parts list

FUJISJ 电梯易损备品备件清单

| Items 序号 | Consuming parts 易损件备品 | Used for specific parts 所用设备 | Manufacturer 制造厂 | Quantity 数量 |
|----------|--------------------------------|---------------------------------|---------------------|----------------|
| 1 | Landing door Slider 层门滑块 | Landing door sill 层门地坎 | FUJISJ | 20 |
| 2 | Car oil cup 轿厢油杯 | Car top 轿厢顶 | FUJISJ | 4 |
| 3 | Counter weight oil cup 对重油杯 | Sub guide rail 副导轨 | FUJISJ | 4 |
| 4 | Oil box 接油盒 | Pit 底坑 | FUJISJ | 8 |
| 5 | Limit switch (NC)限位开关 (常闭) | Shaft 井道 | FUJISJ | 2 |
| 6 | Door lock contact 门锁触点 | Landing door 厅门 | FUJISJ | 5 |
| 7 | Female Lock contact 付锁触点 | Landing door 厅门 | FUJISJ | 5 |
| 8 | Car guide shoe 轿厢导靴靴衬 | Guide rail 导轨 | FUJISJ | 5 |
| 9 | Counter weight guide shoe 对重靴衬 | Guide rail 导轨 | FUJISJ | 5 |
| 10 | Lighting switch 照明开关 | Switch 开关 | FUJISJ | 5 |
| 11 | Triangle lock 三角锁 | Guide rail 厅门 | FUJISJ | 5 |
| 12 | Multi-functional keys 多功能钥匙 | Guide rail 厅门 | FUJISJ | 5 |
| 13 | Fuse 控制柜保险丝 | Controller 控制柜 | FUJISJ | 5 |
| 14 | Anti-collision rubber pad 防撞 | Landing door 厅门 | FUJISJ | 5 |
| 合计 Total | 83pcs / 83 件 | | | |

注：最终解释权归本公司所有

Note: The final interpretation right belongs to the company.

Tel: +86-29-81504031

Web: <https://www.elevator-fuji.com>

Head Office Address: F18, Xinyuan Centre, No.287, Fenghe road , lianhu district , xian city , Shaanxi Province, china

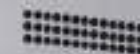

High speed elevator

Adopt super high speed elevator serial control system

The control system adopts a 32-bit networked intelligent serial communication elevator special control system, which greatly improves the CPU operation speed. The four-layer sheet paste technology, CAN bus serial communication, thus ensuring a large amount of data high-speed reliable transmission.

It applies new style shock-absorbing device.

It sets shock-absorbing device to isolate shock between elevator car and car frame. It nicely buffers vibration in the elevator running process. It reduces the elevator car vibration and enhances the passengers' comfortable travel.

Combined car wall connection ensures static car effects, fine sealing and stability of air pressure.



Small machine room passenger elevator

The small machine room passenger elevator adopts an energy-efficient, low-speed, permanent-magnet synchronous gearless traction machine. Compared with a geared elevator with equivalent load level, it saves about 33% of energy. The specially designed small-size control cabinet combines the most advanced low-loss IGBTs and the best design solutions to make the room space perfectly arranged.

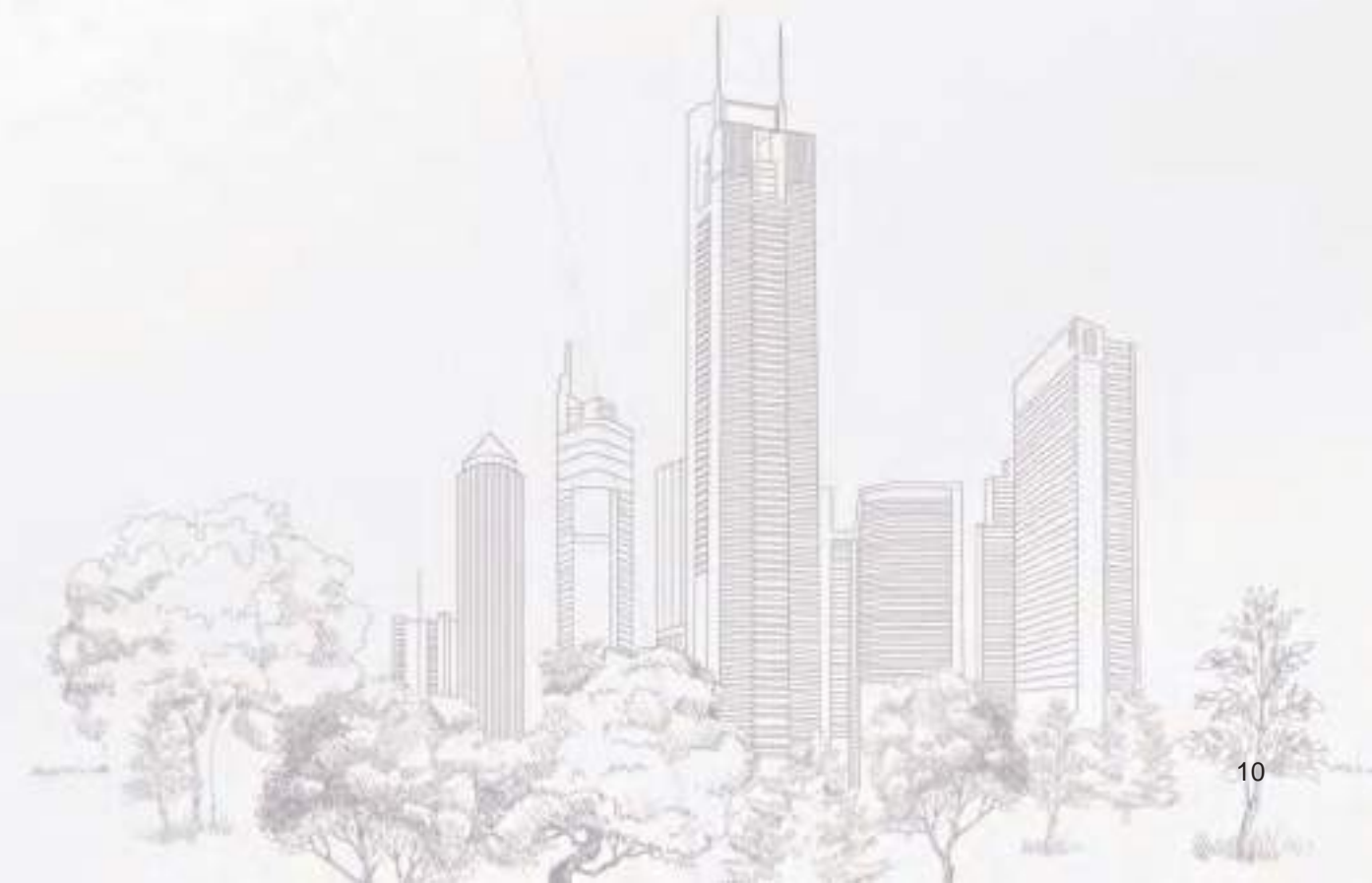

Machine roomless passenger elevator

The elevator without machine room passengers is well aware of the concept of environmental protection, saving energy and reducing consumption, saving floor space and improving design freedom. Compared with geared elevators of the same load class, energy savings are more than 33%. FUJI machine-room passenger lift broke through the premise that the elevator must set up a machine room, providing perfect creation for the limited space of modern architecture.



Car decoration

JG-K01 ▶

Ceiling : Central image arch, stainless steel
bottom panel is supplemented with soft
lighting design of down lamp on both sides
Car wall : Mirror, etched, hairline
Handrail : Stainless steel tube handrail
Floor : PVC



JG-K03 ◀

Ceiling : Stainless steel mirror hollow plate and white
organic board, Aluminum alloy frame
Car wall : Titanium, mirror, etched, hairline, vibration
Handrail : Titanium stainless steel triple combination
Floor : PVC



JG-K02 ◀

Ceiling : Central image arch, stainless steel
bottom panel is supplemented with soft
lighting design of down lamp on both
sides
Car wall : Mirror, etched, hairline
Handrail : None
Floor : PVC

JG-K04 ▶

Ceiling : Stainless steel mirror base plate, golden
down lamp and car wall enhance each
other's beauty. Central part is soft
lighting design of arch white organic
light-emitting board.
Car wall : Mirror, etched, hairline
Handrail : Stainless steel flat handrail
Floor : PVC



Car decoration

JG-K05 ▶

Ceiling : Etched titanium gold mirror, central ceiling lamp, LED at four sides
Car wall : Marble or imitation marble grain, etched titanium-plated stainless steel mirror, titanium gold mirror stainless steel
Handrail : None
Floor : PVC



JG-K07 ◀

Ceiling : Central white light-emitting panel, veneer or imitation veneer model craft panel and auxiliary lighting of down lamp at four sides
Car wall : Veneer or imitation veneer decoration panel combines with titanium gold stainless steel
Handrail : Wood handrail
Floor : PVC



JG-K08 ◀

Ceiling : Veneer or imitation veneer frame,white organic panel, mirror frame
Car wall : Veneer or imitation veneer surface,central make-up mirror
Handrail : Combination of round wood and titanium gold
Floor : PVC

JG-K09 ▶

Ceiling : Hairline stainless steel frame, acrylic light-emitting panel
Car wall : Hairline, mirror, etched
Handrail : Stainless steel flat handrail
Floor : PVC



Car decoration

JG-K10 ▶

Ceiling : Stainless steel side frame, organic strip decoration, ventilation hole, central acrylic arch
Car wall: PVD coated etched stainless steel
Handrail: None
Floor : PVC



JG-K11 ◀

Ceiling : Bronze mirror frame matches with acrylic lighting decoration
Car wall : Irregular grain stainless steel is inlaid with stainless steel mirror strip
Handrail : None
Floor : Marble parquet or imitation marble PVC



JG-K14 ◀

Ceiling : Hairline stainless steel frame, acrylic light-emitting panel, down lamp
Car wall : Marble or imitation marble grain, mirror etching stainless steel
Handrail : None
Floor : PVC

JG-K17 ▶

Ceiling : Mirror stainless steel frame, acrylic light-emitting panel
Car wall : Printed safety glass, mirror stainless steel
Handrail : Stainless steel flat handrail
Floor : PVC



JG-K18 ◀

Ceiling : Black titanium mirror stainless steel frame, acrylic lighting decoration
Car wall : Black titanium mirror etched stainless steel on both sides, soft package on back wall center plate, auxiliary plate black titanium mirror stainless steel
Handrail : None
Floor : PVC



Observation elevator

Up/down flowing scene

With a transparent car design, it is possible to realize the beautiful sight of the sightseeing area and enjoy the beautiful scenery in the urban architectural complex. Applicable to hotels, shopping malls, public buildings and other places.

Observation elevator car decoration



JG-G01 ◀

- Car cover : Back enamel steel, hairline stainless steel, lighting decoration
- Observation wall : 6+6 laminated safety glass (3PCS)
- Decoration ceiling : Hairline stainless steel, acrylic lighting decoration, down lamp
- Car wall : Hairline stainless steel
- Handrail : Stainless steel tube handrail
- Floor : PVC



JG-G02 ◀

- Car cover : Steel plate baked enamel pressed reinforced bar, acrylic strip lighting decoration
- Observation wall : Round 6+6 laminated safety glass (3PCS)
- Decoration ceiling : Baked enamel steel frame, acrylic lighting decoration
- Car wall : Hairline stainless steel
- Handrail : Stainless steel tube handrail
- Floor : PVC



JG-G03 ◀

- Car cover : Baked enamel steel plate, lamp strip decoration
- Observation wall : Round 6+6 laminated safety glass (3PCS)
- Decoration ceiling : Baked enamel steel frame, acrylic lighting decoration
- Car wall : Hairline stainless steel
- Handrail : Stainless steel double tube
- Floor : PVC

Observation elevator car decoration



JG-G04 ◀

- Car cover : Round chamfer baked enamel steel plate, slant face with down lamp
- Observation wall : Round 6+6 laminated safety glass (3PCS)
- Decoration ceiling : Baked enamel steel frame, acrylic light-emit-ting panel and down lamp
- Car wall : Hairline stainless steel
- Handrail : Stainless steel tube
- Floor : PVC



JG-G05 ◀

- Car cover : Steel plate baked enamel pressed reinforced bar, acrylic lighting decoration
- Observation wall : Round 6+6 laminated safety glass (3PCS)
- Decoration ceiling : Baked enamel steel, cylindrical acrylic crystal lamp
- Car wall : Hairline stainless steel
- Handrail : Stainless steel double tube
- Floor : PVC



JG-G06 ◀

- Car cover : Creamy white acrylic hood, 3D steel plate model, down lamp
- Observation wall : 6+6 laminated safety glass (3PCS)
- Decoration ceiling : Baked enamel steel top panel, Central round acrylic lighting decoration, acrylic crystal lamp decoration
- Car wall : Hairline stainless steel
- Handrail : Stainless steel tube
- Floor : PVC



JG-G08 ◀

- Car cover : Baked enamel steel, lighting decoration
- Observation wall : 6+6 laminated safety glass (3PCS)
- Decoration ceiling : Baked enamel steel, acrylic lighting decoration
- Car wall : Hairline stainless steel
- Handrail : Stainless steel double tube
- Floor : PVC

Hospital elevator

A beautiful human-oriented world

FUJI hospital elevator series, taking full account of the uniqueness of the hospital environment, using the world's cutting-edge modular computer control technology, formed a highly integrated VVVF serial communication control system, So that the elevator brake smooth, smooth operation, patient times Feel comfortable. The design of multiple safety features effectively reduces the probability of accidents and allows safe and inaccessible patients access.



Hospital elevator car decoration

JG-B01 ▶

- Ceiling : Hairline stainless steel LED energy saving light
- Ventilation : Axial fan
- Car wall: Hairline stainless steel
- Handrail: Double flat stainless steel
- Floor : PVC floorboard

Negative ion car technology

Leading the use of natural oxygen bar car technology, air negative ions are like vitamins in food, increasing negative oxygen ions to improve the air quality of car, more conducive to patients riding the ladder.



JG-B02 ▶

- Ceiling : Painted steel plate, LED energy saving light
- Ventilation : Axial fan
- Car wall: Hairline stainless steel
- Handrail: Stainless steel tube
- Floor : PVC floorboard

Ultraviolet sterilizer

Considering the complexity of the people used in the hospital bed elevator, ultraviolet sterilization device is installed in the car, and ultraviolet disinfection is carried out when the elevator starts. Dust removal and decontamination, disinfection and sterilization, smoke elimination and deodorization, etc.





Villa elevator

Perfect & comfortable life

Designed to match the distinguished experience of a stylish home in a luxury private home, it is designed primarily for home users. Its sophisticated layout, variety of styles, and outstanding performance make it an indispensable luxury furniture for your villa home.



Villa elevator car decoration

FSJG-V003 ▶

- Ceiling: Titanium gold stainless steel frame, Central acrylic decoration, LED down lamp
- Car wall: Titanium gold, mirror, Etched staninless steel
- Handrail: None
- Floor: Marble



FSJG-V004 ◀

- Ceiling: Titanium gold mirror stainless steel frame,acrylic light decoration, LED down lamp
- Car wall: Titanium gold stainless steel, Titanium gold mirror stainless steel(Rear wall central panel)
- Handrail: None
- Floor: Marble



FSJG-V006 ◀

- Ceiling: Wooden decoration inlaid with titanium gold mirror decoration strip, four-side hidden soft light source, central high grade decoration strip
- Car wall: Wooden model frame inlaid with wooden decoration,etched stainless steel
- Handrail: None
- Floor: Teakwood floor

FSJG-V007 ▶

- Ceiling: Titanium gold mirror stainless steel, acrylic transparent board
- Car wall: Titanium gold mirror stainless steel, Titanium gold vibration plate
- Handrail: Golden stainless steel round tube handrail
- Floor: Marble parquet (optional PVC)



Villa elevator car decoration

FSJG-V008 ▶

- Ceiling: Titanium gold mirror frame, acrylic lighting decoration, down lamp
- Car wall: Titanium gold and corrugated mirror stainless steel, Titanium gold mirror stainless steel
- Handrail: Titanium gold mono-tube round handrail
- Floor: Marble parquet (optional PVC)



JG-K15 ◀

- Ceiling: Mirror stainless steel frame, acrylic lighting decoration
- Car wall: Veneer or imitation veneer decoration panel, mirror stainless steel
- Handrail: Wood handrail
- Floor: PVC



JG-K13 ◀

- Ceiling: Painted steel plate, central titanium gold stainless steel mirror, down lamp
- Car wall: Veneer or imitation veneer decoration panel, Titanium gold etching stainless steel
- Handrail: Combined handrail of titanium gold and solid wood
- Floor: PVC

JG-K19 ▶

- Ceiling: Stainless steel frame, Acrylic lighting decoration, Down lamp
- Car wall: Hairline stainless steel, Mirror stainless steel
- Handrail: None
- Floor: PVC





Freight elevator

FUJI cargo elevators are easy to carry and adapt under all kinds of operating conditions, making more weightlifting and more than adequate. Create a new concept of cargo delivery.

Machine roomless freight elevator

FUJI machine-room-less elevator products are designed with low-carbon and environmental protection, saving energy and reducing consumption, fully embodying the product's green humanistic spirit. Compared with geared elevators of the equivalent load class, electric energy is saved by about 40%, saving 10% of the building area.

Freight elevator car decoration

JG-J60 ▼

Ceiling: Paint steel
Car wall/Car door: Paint steel
Illumination: Energy-saving light
Door opening mode: Side opening
Floor: Checkered plate



JG-J61 ▼

Ceiling: Hairline stainless steel
Car wall/Car door: Hairline stainless steel
Illumination: Energy-saving light
Door opening mode: Center-opening & doublefolded type
Floor: Checkered plate





Escalator

FUJI escalators are manufactured using international advanced technology and advanced design concepts to provide passengers with a new feeling of brightness and comfort, allowing you to appreciate the extraordinary charm and luxury of modern architecture.



Moving walk

The compact design of the rail pre-assembly technology and mechanical system of the FUJI moving walkway and the handrail drive system has reduced the size of the sidewalk and enabled the building's space to be used effectively.

Human-machine interface



JG-CZ001
Optional

Display optional

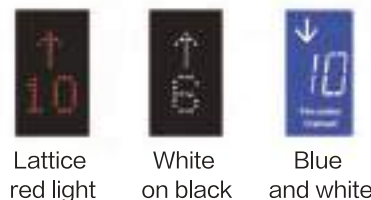

Lattice red light
White on black
Blue and white

None bottom outer calling



JG-108e
Optional

JG-108f
Optional



JG-108h
Optional
Super-thin



JG-108d
Optional



JG-108g
Optional
Super-thin



JG-340
Optional

Have bottom outer calling



JG-340a
Optional



JG-340b
Optional



JG-340c
Optional



JG-006
Optional



JG-006a
Optional



JG-006b
Optional



JG-006c
Optional

Man-Machine interface

JG-108

Optional

Optional display
Optional : Hairline,
Black Titanium gold

Display screen



Blue screen
Optional



True color
Optional



Multi-Media
Optional

Multimedia display size : 7 inch,10 inch

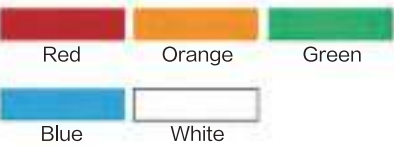

Due to the limitations of the printing process, the color of the actual processing may be slightly different from the catalog, and the final selection may be based on the actual material and the color sample.

Hoist-way horizontal display



JG-HX01

Optional



JG-HX02

Optional

Arrival gong



JG-DZ01

Optional



JG-DZ02

Optional



JG-131

Optional

Have bottom
outer calling



JG-131a

Optional

Ceiling series

Each detail is crafted, Zhenyu is perfect, shows the beauty of modern craftsmanship, merges with architecture, and pours in pursuit of excellence

JG-D01

Baked enamel steel frame, circle carve transparent light and vaulted white transparent light board for soft illumination design



JG-D03

Baked enamel steel frame, circle carve transparent light and vaulted white transparent light board for soft illumination design



JG-D04

Middle with image roof, side of stainless steel floor with down lamp for soft illumination design



JG-D05

Multi-layer glisten board and stainless steel mirror carve board with transparent light for soft illumination design



JG-D06

Stainless steel mirror hollow pale with white organic panel,aluminum alloy frame



JG-D07

Integrated ceiling

Mirror stainless steel,acrylic lighting decoration, LED lamps on both sides



JG-D07B

Integrated ceiling

Mirror stainless steel,acrylic lighting decoration



JG-D08

Stainless steel frame with white organic panel



Landing door series



JG-M01 JG-M02 JG-M03 JG-M04



JG-M05 JG-M06 JG-M07 JG-M08

Optional color series



Floor series



JG-F01 JG-F02 JG-F03



JG-F04 JG-F05 JG-F06



JG-F07 JG-F08 JG-F09

Handrail series



Note : Due to the limitations of the printing process, the color of the actual processing may be slightly different from the catalog, and the final selection may be based on the actual material and the color sample.

Perfect function

| Standard function | |
|---|---|
| VVVF drive | Motor rotating speed can be precisely adjusted to get smooth speed curve in lift start, travel and stop and gain the sound comfort. |
| VVVF door operator | Motor rotating speed can be precisely adjusted to get the more gentle and sensitive door machine start / stop. |
| Independent running | The lift can not respond to outer calling, but only respond to the command inside the car through the action switch. |
| Automatic pass without stop | When the car is crowded with the passengers or the load is closeto preset value, the car will automatically pass the calling landing in order to keep maximum travel efficiency. |
| Automatically adjust door opening time | Door–open time can be automatically adjusted according to the difference between landing calling or car calling. |
| Reopen with hall call | In the door shutting process, press reopen with hall call button can restart the door. |
| Express door closing | When the lift stops and opens the door, press door–shut button, the door will be closed immediately. |
| Car stops and door open | The lift decelerates and levels, the door only opens after the lift comes to a complete stop. |
| Car arrival gong | Arrival tong in the car top announces that the passengers arrive. |
| Command register cancel | If you press the wrong floor command button in the car, twice continuous pressing of same button can cancel the registerec command. |
| Photocell protection | In the door open and shut period, infrared light that covers the whole door height is used to probe the door protection device of both the passengers and objects. |
| Designated stop | If the lift can not open the door in the destination floor out of some reason, the lift will close the door and travel to the next designated floor. |
| Overload holding stop | When the car is overload, the buzzer rings and stops the lift in the same floor. |
| Anti–stall timer protection | The lift stops operation due to slippery traction wire rope. |
| Start protection control | If the lift does not leave door zone within the designated time after it gets started, it will stop the operation. |
| Inspection operation | When the lift enters into inspection operation, the car travels at inching running. |
| Fault self–diagnosis | The controller can record 62 latest troubles so as to quickly remove the trouble and restore the lift operation. |
| Repeated door closing | If the lift can not close the door due to certain obstacle or interference, the lift will reopen or re– shut the door until sundries are eliminated. |
| Up/down over–run and final limitprotection | The device can effectively prevent from the lift' s surging to the top or knocking the bottom when it is out of the control. It results in the more safe and reliable lift travel. |
| Down over– speed protection device | When the lift downs 1.2 times higher than the rated speed, this device will automatically cut off control mains, stop the motor running so as to stop lift down at over–speed. If the lift continues to down at over– speed, and the speed is 1.4 times higher than rated speed, safety tongs act to force the lift stop in order to ensure the safety. |
| Upward over–speed protection device | When the lift ups 1.2 times higher than rated speed, the device will automatically decelerate or brake the lift. |
| Micro–touch button for car call and hall call | Novel micro–touch button is used for operation panel command button in the car and landing calling button. |
| Floor and direction indicator inside car | The car shows the lift floor location and current travel direction. |
| Floor and direction indicator | The landing shows the lift floor location and current travel direction. |
| Emergency car lighting | Emergency car lighting automatically activated once power failure. |
| Inching running | When the lift enters into emergency electric operation, the car travels at low speed inching running. |

| | |
|--|--|
| Five way intercom | Communication amid car, car top, lift machine room, well pit and rescue duty room through walkie–talkie. |
| Bell | In emergency conditions, if bell button above car operation panel is continuously pressed, electric bell rings on top of the car. |
| Fire emergency return | If you start key switch in main landing or monitor screen, all the callings will be cancelled. The lift directly and immediately drives to the designated rescue landing and automatically opens the door. |
| Car vniation, light automatic shut off | If there is no dling or command signal within the stipulated time, the car fan and lighting will be automatically closed in order to save the energy. |
| Remote shut–off | The lift can be called to main landing (after finishing the service) through the key switch and automatically exists the service. |

| Optional function | |
|----------------------------------|--|
| Leveling when power failure | In normal power failure, the chargeable battery supplies the lift power. The lift drives to the nearest landing. |
| Anti–nuisance | In the light lift load, when three more commands appear, in order to avoid the unnecessary parking, all the registered callings in the car will be cancelled. |
| Open the door in advance | When the lift decelerates and enters into door open zone, it automatically opens the door to enhance the travel efficiency. |
| Direct parking | It completely accords with distance principle with no crawling in the leveling. It greatly enhances the travel efficiency. |
| Group control function | When three or more same model lift groups are controlled in use, the lift group can automatically choose the most appropriate response. It avoids the repeated lift parking, reduces the passengers’ waiting time and increases the travel efficiency. |
| Duplex control | Two sets of same model lifts can unanimously respond the calling signal through the computer dispatch. In this way, it reduces the passengers’ waiting time to the greatest extent and enhances the travel efficiency as well. |
| On–duty peak service | Within the preset on– duty time, upward transport from the home landing is extremely busy. The lifts are continuously dispatched to the home landing in order to satisfy on–duty peak service. |
| Off–duty peak service | Within the preset off–duty period, the lifts are continuously dispatched to top floor in order to satisfy off–duty peak service. |
| Door open time extending | Press special button in the car, the lift door keeps open for certain period of time. |
| Voice announcer | When the lift normaly arrives, voice announcer informs the passengers about the relevant information |
| Car assistant operatin box | It is used in the large loading weight lifts or the lifts with crowded passengers so that more and more passengers can use the car. |
| Operation box for the hndicapped | It is convenient for the wheelchair passengers and those who have vision problems. |
| Intlligent alling service | The car command or hoist–way calling can be locked or connected through special Intelligent Input. |
| IC card control function | All (partial) landings can only input car commands through IC Card after the authorization. |
| Remote monitor | The lift long–distance monitor and control can be fulfilled through modem and telephone. It is convenient for the factories and service units to timely know the travel conditions of every lift and promptly take the corresponding measures. |
| Remote control | The lift can have independent travel according to the specific requirements through operation monitor screen (optional). |
| Camera function in the car | The camera is installed in the car to monitor the car conditions. |

Small machine room passenger elevator construction sketch

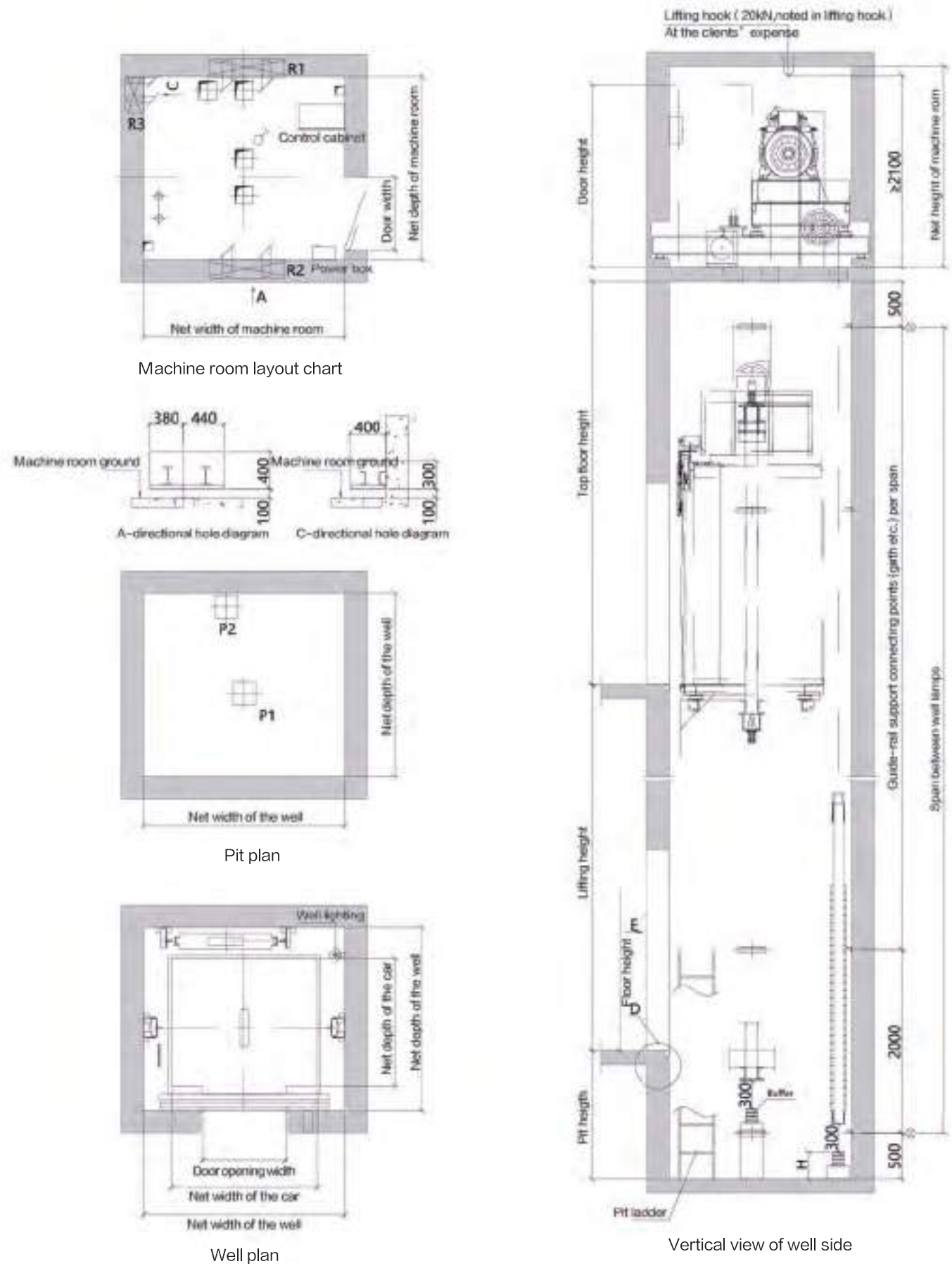

| Model | Load KG | Passenger NO. | speed m/s | Car specification CWxCD | Door opening size JJxOPH | Well size HWxHD | Machine room size MRWxMRD | Pit depth Pit | Top floor height OH | Power | Acting force | | | | |
|--------------|------------|------------------|--------------|----------------------------|-----------------------------|--------------------|------------------------------|------------------|------------------------|-------|--------------|-------|------|--------|-------|
| | | | | | | | | | | | R1 | R2 | R3 | P1 | P2 |
| TKJ450/1.0 | 450 | 6 | 1 | 1100x1100 | 700x2100 | 1700x1700 | 1700x1700 | 1400 | 4500 | 3.2 | 28800 | 17200 | 1900 | 44000 | 35000 |
| TKJ450/1.5 | | | 1.5 | | | | | 1500 | 4600 | 4.9 | | | | | |
| TKJ630/1.0 | 630 | 8 | 1 | 1400x1100 | 800x2100 | 2000x1700 | 2000x1700 | 1400 | 4500 | 4.3 | 35200 | 21800 | 4300 | 58000 | 45600 |
| TKJ630/1.5 | | | 1.5 | | | | | 1500 | 4600 | 6.4 | | | | | |
| TKJ630/1.75 | | | 1.75 | | | | | 1600 | 4700 | 7.5 | | | | | |
| TKJ800/1.0 | 800 | 10 | 1 | 1400x1350 | 800x2100 | 2000x2000 | 2000x2000 | 1400 | 4500 | 5.4 | 44800 | 27400 | 5400 | 72000 | 56000 |
| TKJ800/1.5 | | | 1.5 | | | | | 1500 | 4600 | 8.1 | | | | | |
| TKJ800/1.75 | | | 1.75 | | | | | 1600 | 4700 | 9.4 | | | | | |
| TKJ1000/1.0 | 1000 | 13 | 1 | 1600x1400 | 900x2100 | 2200x2000 | 2200x2000 | 1400 | 4500 | 6.7 | 53400 | 32200 | 6000 | 88000 | 68000 |
| TKJ1000/1.5 | | | 1.5 | | | | | 1500 | 4600 | 10 | | | | | |
| TKJ1000/1.75 | | | 1.75 | | | | | 1600 | 4700 | 11.7 | | | | | |
| TKJ1150/1.0 | 1150 | 15 | 1 | 1900x1400 | 1000x2100 | 2500x2100 | 2500x2100 | 1400 | 4600 | 7.8 | 55600 | 36300 | 7800 | 98000 | 75000 |
| TKJ1150/1.5 | | | 1.5 | | | | | 1500 | 4700 | 11.7 | | | | | |
| TKJ1150/1.75 | | | 1.75 | | | | | 1600 | 4800 | 13.6 | | | | | |
| TKJ1250/1.0 | 1250 | 16 | 1 | 1900x1500 | 1100x2100 | 2500x2200 | 2500x2200 | 1400 | 4600 | 8.5 | 60400 | 39400 | 8500 | 106000 | 81000 |
| TKJ1250/1.5 | | | 1.5 | | | | | 1500 | 4700 | 12.7 | | | | | |
| TKJ1250/1.75 | | | 1.75 | | | | | 1600 | 4800 | 14.9 | | | | | |
| TKJ1350/1.0 | 1350 | 18 | 1 | 1900x1600 | 1100x2100 | 2500x2300 | 2500x2300 | 1400 | 4600 | 9.2 | 67200 | 43400 | 8700 | 114000 | 87000 |
| TKJ1350/1.5 | | | 1.5 | | | | | 1500 | 4700 | 13.8 | | | | | |
| TKJ1350/1.75 | | | 1.75 | | | | | 1600 | 4800 | 16.1 | | | | | |
| TKJ1600/1.0 | 1600 | 21 | 1 | 2000x1750 | 1200x2100 | 2600x2450 | 2600x2450 | 1400 | 4600 | 11 | 73600 | 47600 | 9600 | 128000 | 96000 |
| TKJ1600/1.5 | | | 1.5 | | | | | 1500 | 4700 | 16.6 | | | | | |
| TKJ1600/1.75 | | | 1.75 | | | | | 1600 | 4800 | 19.4 | | | | | |

(The data is for design reference only. Regarding detailed parameters, please take technical drawing as criterion.)
Note: If specification exceeds above range, please contact FUJI Elevator Company.

Machine room-less passenger elevator construction sketch(economical)

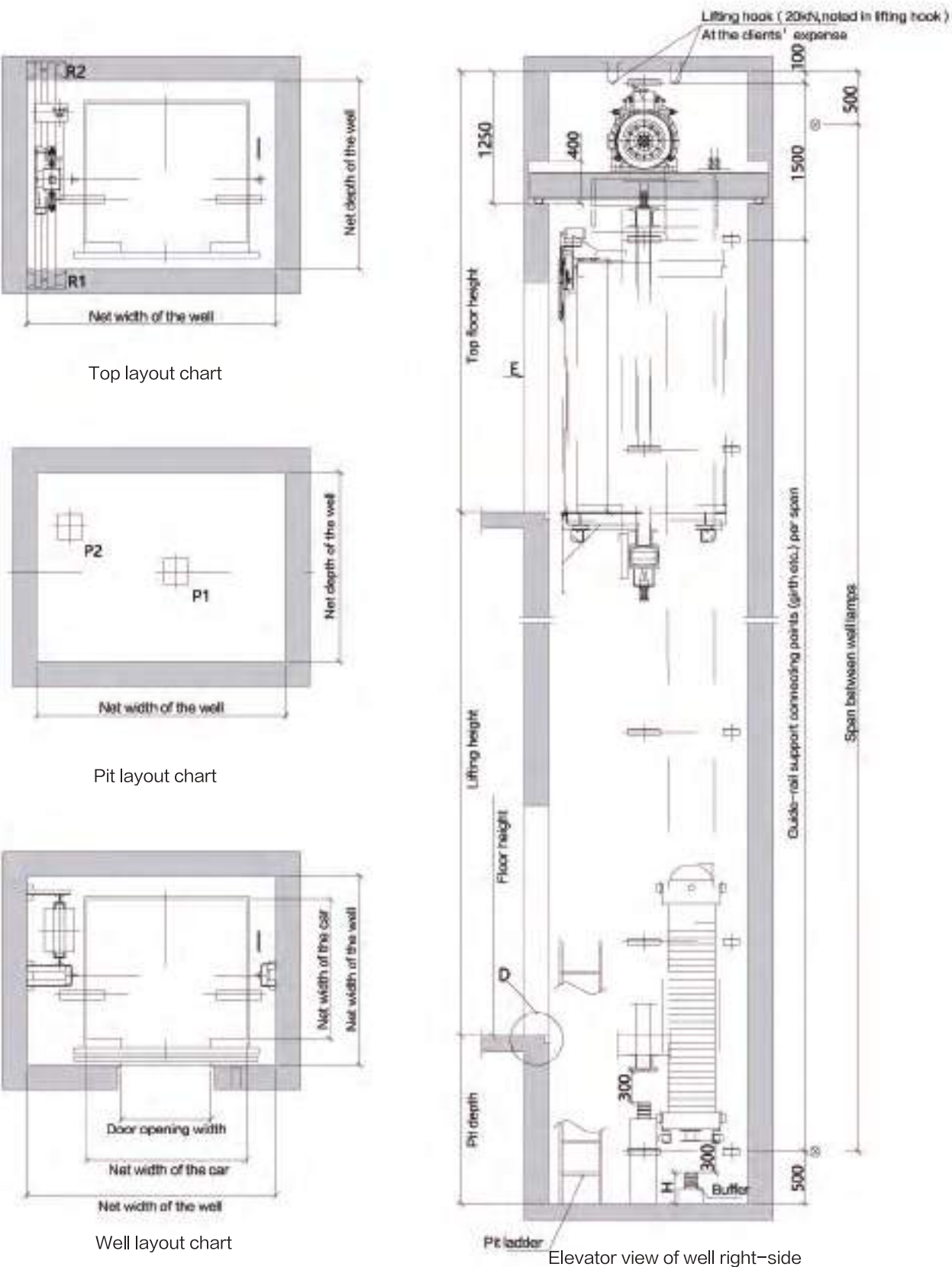

| Model | Load KG | Passenger NO. | speed m/s | Car specification CWxCD | Door opening size JJxOPH | Well size HWxHD | Pit depth Pit | Top floor height OH | Power | Acting force | | | |
|---------------|------------|------------------|--------------|----------------------------|-----------------------------|--------------------|------------------|------------------------|-------|--------------|-------|--------|-------|
| | | | | | | | | | | R1 | R2 | P1 | P2 |
| TKJW450/1.0 | 450 | 6 | 1 | 1100x1100 | 700x2100 | 2000x1700 | 1600 | 4300 | 3.2 | 16500 | 21000 | 44000 | 35000 |
| TKJW450/1.5 | | | 1.5 | | | | 1700 | 4400 | 4.9 | | | | |
| TKJW630/1.0 | 630 | 8 | 1 | 1400x1100 | 800x2100 | 2300x1700 | 1600 | 4300 | 4.3 | 19800 | 26400 | 58000 | 45600 |
| TKJW630/1.5 | | | 1.5 | | | | 1700 | 4400 | 6.4 | | | | |
| TKJW630/1.75 | | | 1.75 | | | | 1700 | 4400 | 7.5 | | | | |
| TKJW800/1.0 | 800 | 10 | 1 | 1400x1350 | 800x2100 | 2300x2000 | 1600 | 4300 | 5.4 | 25700 | 27100 | 72800 | 56000 |
| TKJW800/1.5 | | | 1.5 | | | | 1700 | 4400 | 8.1 | | | | |
| TKJW800/1.75 | | | 1.75 | | | | 1700 | 4400 | 9.4 | | | | |
| TKJW1000/1.0 | 1000 | 13 | 1 | 1600x1400 | 900x2100 | 2500x2000 | 1600 | 4300 | 6.7 | 27400 | 39600 | 88000 | 68000 |
| TKJW1000/1.5 | | | 1.5 | | | | 1700 | 4400 | 10 | | | | |
| TKJW1000/1.75 | | | 1.75 | | | | 1700 | 4400 | 11.7 | | | | |
| TKJW1150/1.0 | 1150 | 15 | 1 | 1900x1400 | 1000x2100 | 2800x2000 | 1600 | 4300 | 7.8 | 30400 | 43600 | 92000 | 75000 |
| TKJW1150/1.5 | | | 1.5 | | | | 1700 | 4400 | 11.7 | | | | |
| TKJW1150/1.75 | | | 1.75 | | | | 1700 | 4400 | 13.6 | | | | |
| TKJW1250/1.0 | 1250 | 16 | 1 | 1900x1500 | 1100x2100 | 2900x2000 | 1600 | 4300 | 8.5 | 32200 | 46800 | 106000 | 81000 |
| TKJW1250/1.5 | | | 1.5 | | | | 1700 | 4400 | 12.7 | | | | |
| TKJW1250/1.75 | | | 1.75 | | | | 1700 | 4400 | 14.9 | | | | |
| TKJW1350/1.0 | 1350 | 18 | 1 | 1900x1600 | 1100x2100 | 2900x2400 | 1600 | 4400 | 9.2 | 37600 | 46400 | 114000 | 87000 |
| TKJW1350/1.5 | | | 1.5 | | | | 1700 | 4500 | 13.8 | | | | |
| TKJW1350/1.75 | | | 1.75 | | | | 1700 | 4500 | 16.1 | | | | |
| TKJW1600/1.0 | 1600 | 21 | 1 | 2000x1750 | 1200x2100 | 3000x2400 | 1600 | 4400 | 11 | 39600 | 56500 | 128000 | 96000 |
| TKJW1600/1.5 | | | 1.5 | | | | 1700 | 4500 | 16.6 | | | | |
| TKJW1600/1.75 | | | 1.75 | | | | 1700 | 4500 | 19.4 | | | | |

(The data is for design reference only. Regarding detailed parameters, please take technical drawing as criterion.)
Note: If specification exceeds above range, please contact FUJII Elevator Company.

Machine room-less passenger elevator construction sketch(compact)

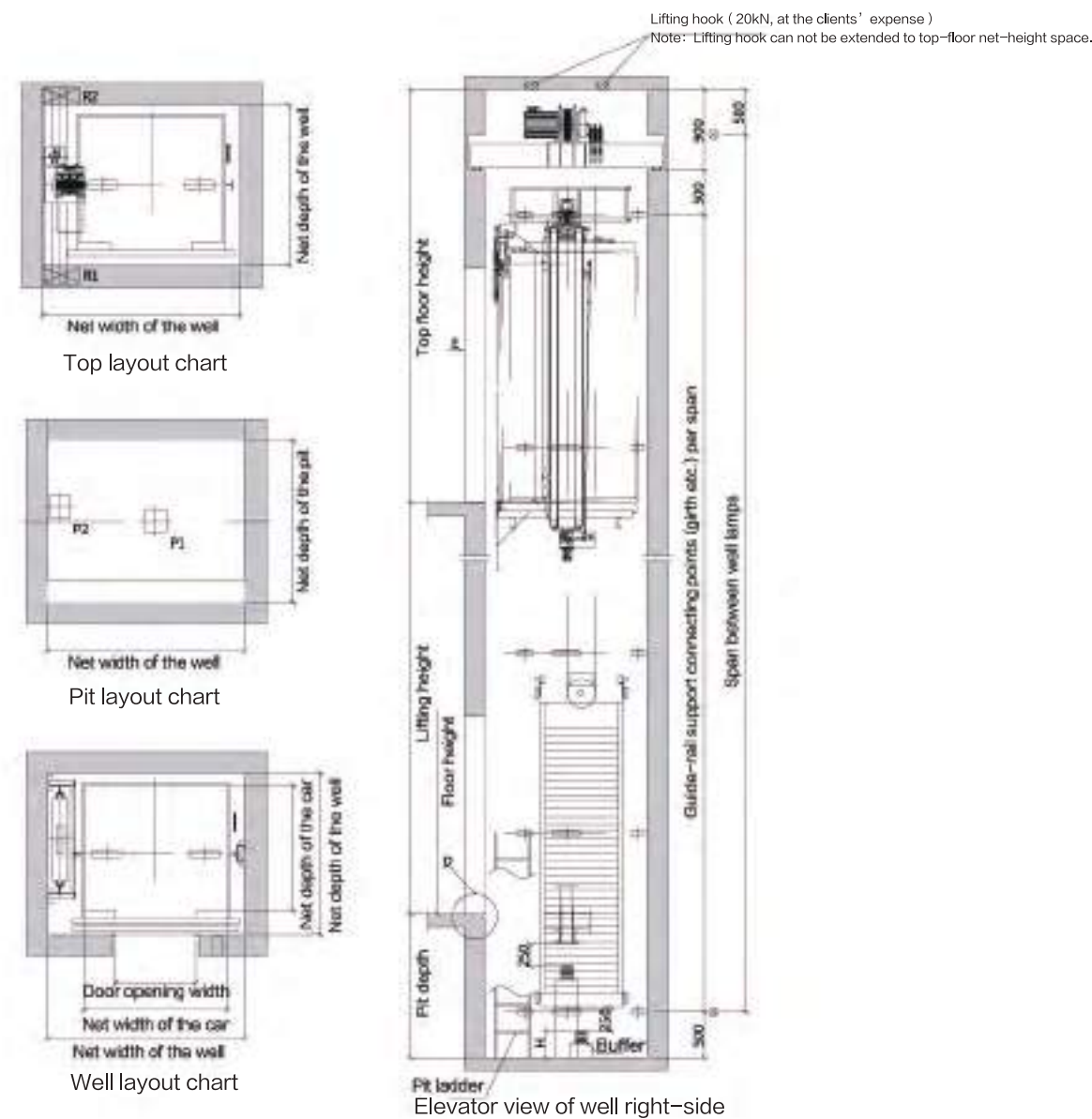

| Model | Load KG | Passenger NO. | speed m/s | Car specification CWxCD | Door opening size JJxOPH | Well size HWxHD | Pit depth Pit | Top floor height OH | Power | Acting force | | | |
|---------------|------------|------------------|--------------|----------------------------|-----------------------------|--------------------|------------------|------------------------|-------|--------------|-------|-------|-------|
| | | | | | | | | | | R1 | R2 | P1 | P2 |
| TKJW630/1.0 | 630 | 8 | 1 | 1200x1350 | 700x2100 | 1850x1750 | 1500 | 4600 | 4.0 | 19800 | 26400 | 58000 | 45600 |
| TKJW630/1.5 | | | 1.5 | | | | 1600 | 4700 | 6.3 | | | | |
| TKJW630/1.75 | | | 1.75 | | | | 1700 | 4800 | 7.3 | | | | |
| TKJW800/1.0 | 800 | 10 | 1 | 1400x1350 | 800x2100 | 2050x1750 | 1500 | 4600 | 5.4 | 25700 | 27100 | 72800 | 56000 |
| TKJW800/1.5 | | | 1.5 | | | | 1600 | 4700 | 8.1 | | | | |
| TKJW800/1.75 | | | 1.75 | | | | 1700 | 4800 | 9.4 | | | | |
| TKJW1000/1.0 | 1000 | 13 | 1 | 1600x1400 | 900x2100 | 2250x1800 | 1500 | 4600 | 6.7 | 27400 | 39600 | 88000 | 68000 |
| TKJW1000/1.5 | | | 1.5 | | | | 1600 | 4700 | 10.1 | | | | |
| TKJW1000/1.75 | | | 1.75 | | | | 1700 | 4800 | 11.8 | | | | |

(The data is for design reference only. Regarding detailed parameters, please take technical drawing as criterion.)
Note: If specification exceeds above range, please contact FUJI Elevator Company.

High speed elevator construction sketch

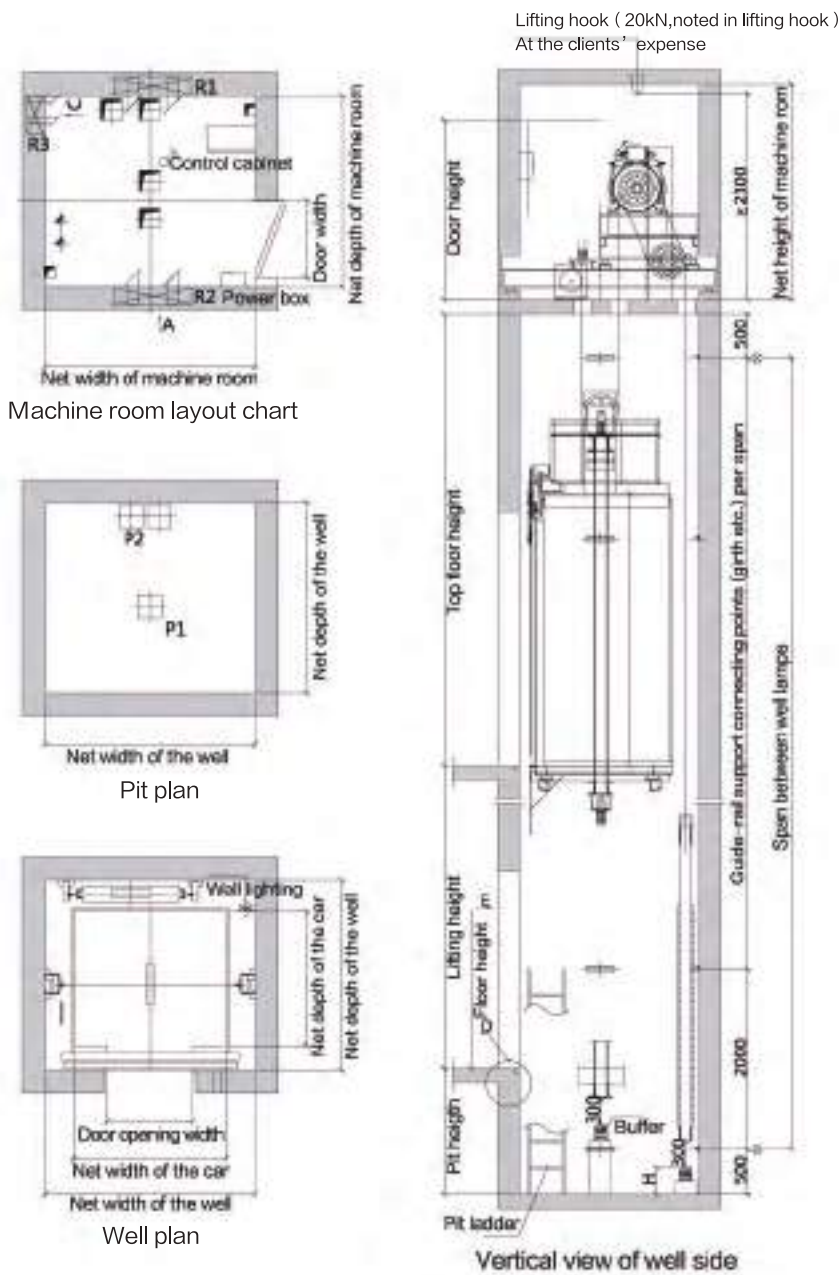

| Model | Load KG | Pas- senger NO. | speed m/s | Car specification CWxCD | Door opening size JJxOPH | Well size HWxHD | Machine room size MRWxMRD | Pit depth Pit | Top floor height OH | Power | Acting force | | | | |
|-------------|------------|-----------------------|--------------|----------------------------|-----------------------------|--------------------|------------------------------|------------------|------------------------|-------|--------------|-------|------|-------|-------|
| | | | | | | | | | | | R1 | R2 | R3 | P1 | P2 |
| TKJ630/2.0 | 630 | 8 | 2 | 1400x1100 | 800x2100 | 2000x1800 | 2000x1800 | 1700 | 5000 | 8.2 | 44800 | 27400 | 5400 | 72000 | 56000 |
| TKJ800/2.0 | 800 | 10 | 2 | 1400x1350 | 800x2100 | 2000x2050 | 2000x2050 | 1700 | 5000 | 10.9 | 44800 | 27400 | 5400 | 72000 | 56000 |
| TKJ800/2.5 | | | 2.5 | | | | | 1900 | 5200 | 13.5 | | | | | |
| TKJ800/3.0 | | | 3 | | | | | 3200 | 5700 | 16.5 | | | | | |
| TKJ1000/2.0 | 1000 | 13 | 2 | 1600x1400 | 900x2100 | 2200x2100 | 2200x2100 | 1700 | 5000 | 13.3 | 53400 | 32200 | 6000 | 88000 | 68000 |
| TKJ1000/2.5 | | | 2.5 | | | | | 1900 | 5200 | 16.8 | | | | | |
| TKJ1000/3.0 | | | 3 | | | | | 3200 | 5700 | 20.3 | | | | | |
| TKJ1000/4.0 | | | 4 | | | | | 4000 | 6200 | 27.1 | | | | | |

(The data is for design reference only. Regarding detailed parameters, please take technical drawing as criterion.)
Note: If specification exceeds above range, please contact FUJI Elevator Company.

Hospital elevator construction sketch

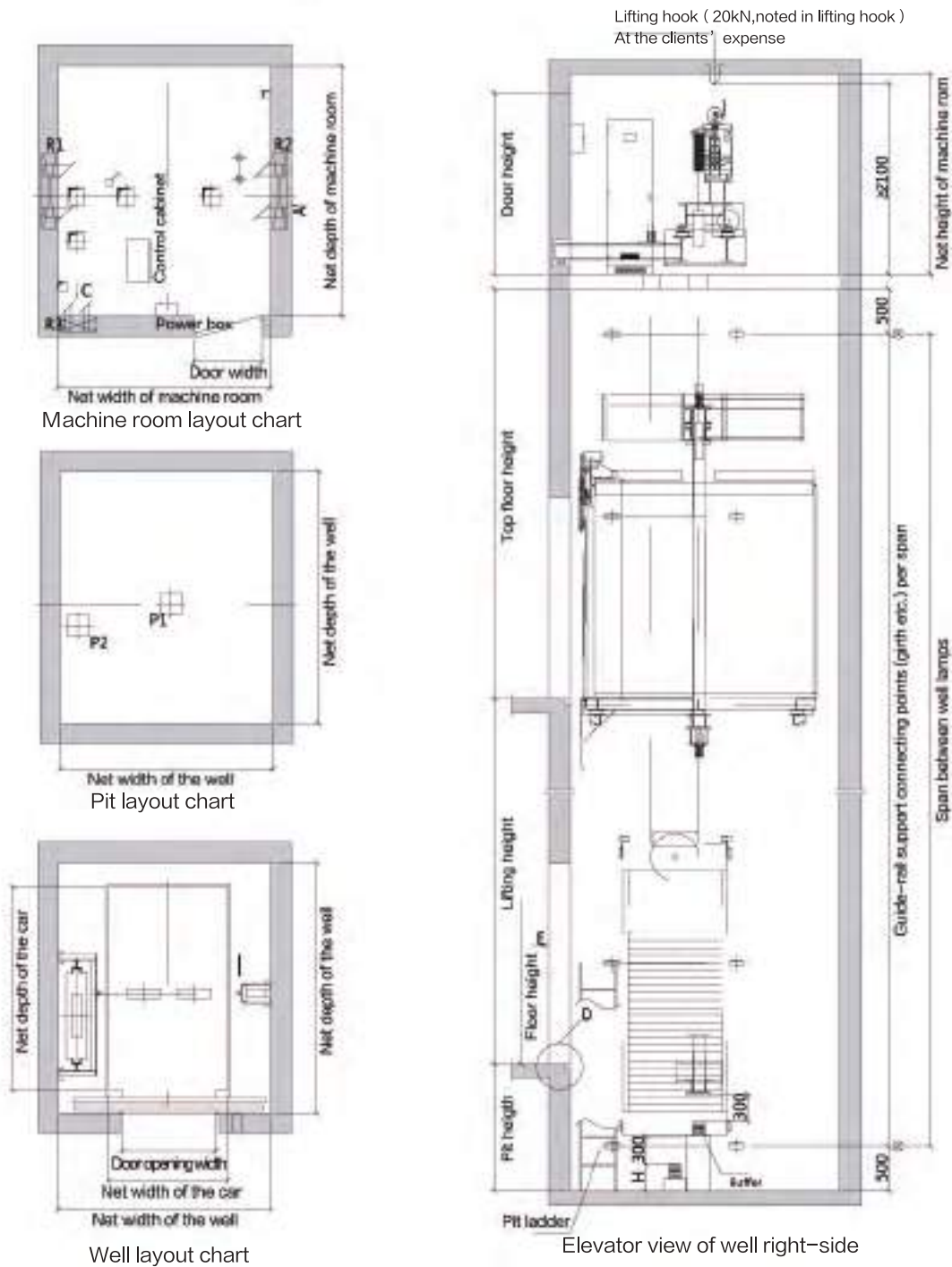

| Model | Load KG | Passenger NO. | speed m/s | Car specification CWxCD | Door opening size JJxOPH | Well size HWxHD | Machine room size MRWxMRD | Pit depth Pit | Top floor height OH | Power | Acting force | | | | |
|--------------|------------|------------------|--------------|----------------------------|-----------------------------|--------------------|------------------------------|------------------|------------------------|-------|--------------|-------|------|--------|-------|
| | | | | | | | | | | | R1 | R2 | R3 | P1 | P2 |
| TBJ1600/1.0 | 1600 | 21 | 1 | 1400x2400 | 1100x2100 | 2500x2950 | 2500x2950 | 1400 | 4600 | 11 | 73600 | 47600 | 9600 | 128000 | 96000 |
| TBJ1600/1.5 | | | 1.5 | | | | | 1500 | 4700 | 16.6 | | | | | |
| TBJ1600/1.75 | | | 1.75 | | | | | 1600 | 4800 | 19.4 | | | | | |

(The data is for design reference only. Regarding detailed parameters, please take technical drawing as criterion.)
Note: If specification exceeds above range, please contact FUJI Elevator Company.

Machine room-less observation elevator construction sketch(square)

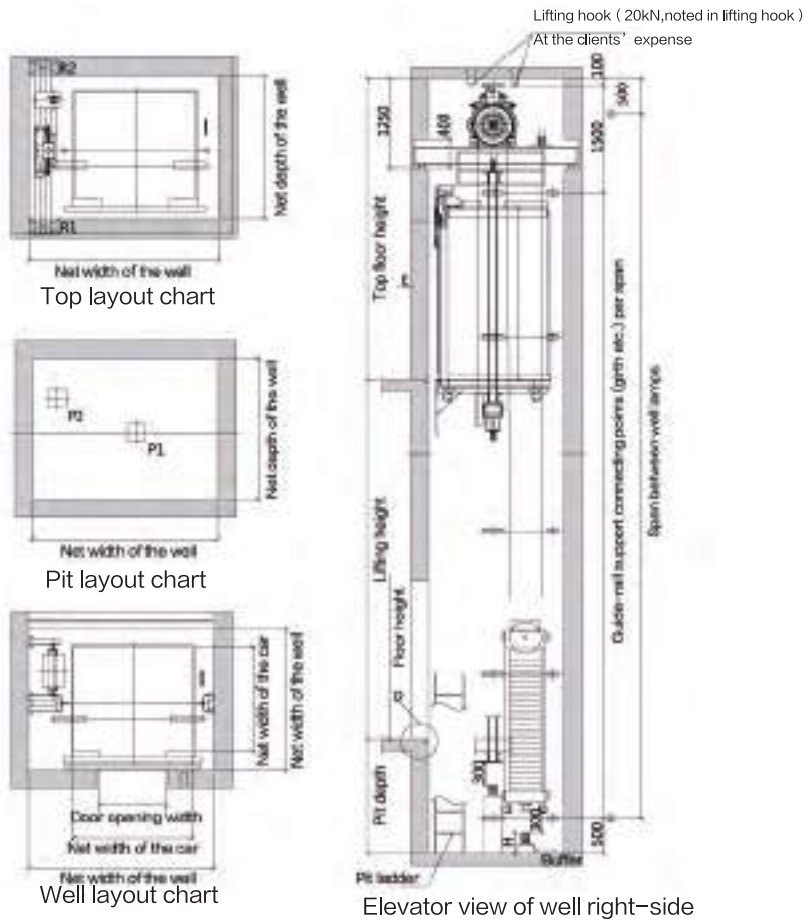

| Model | Load KG | Passenger NO. | speed m/s | Car specification CWxCD | Door opening size JJxOPH | Well size HWxHDmin-HDmax | Pit depth Pit | Top floor height OH | Power | Acting force | | | |
|---------------|------------|------------------|--------------|----------------------------|-----------------------------|-----------------------------|------------------|------------------------|-------|--------------|-------|--------|-------|
| | | | | | | | | | | R1 | R2 | P1 | P2 |
| TGJW450/1.0 | 450 | 6 | 1 | 1100x1100 | 700x2100 | 2000x1700 | 1600 | 4600 | 3.2 | 16500 | 21000 | 44000 | 35000 |
| TGJW450/1.5 | | | 1.5 | | | | 1700 | 4700 | 4.9 | | | | |
| TGJW630/1.0 | 630 | 8 | 1 | 1200x1300 | 800x2100 | 2100x1800 | 1600 | 4600 | 4.3 | 19800 | 26400 | 58000 | 45600 |
| TGJW630/1.5 | | | 1.5 | | | | 1700 | 4700 | 6.4 | | | | |
| TGJW630/1.75 | | | 1.75 | | | | 1700 | 4700 | 7.5 | | | | |
| TGJW800/1.0 | 800 | 10 | 1 | 1400x1350 | 800x2100 | 2300x2000 | 1600 | 4600 | 5.4 | 25700 | 27100 | 72800 | 56000 |
| TGJW800/1.5 | | | 1.5 | | | | 1700 | 4700 | 8.1 | | | | |
| TGJW800/1.75 | | | 1.75 | | | | 1700 | 4700 | 9.4 | | | | |
| TGJW1000/1.0 | 1000 | 13 | 1 | 1600x1400 | 900x2100 | 2500x2000 | 1600 | 4600 | 6.7 | 27400 | 39600 | 88000 | 68000 |
| TGJW1000/1.5 | | | 1.5 | | | | 1700 | 4700 | 10 | | | | |
| TGJW1000/1.75 | | | 1.75 | | | | 1700 | 4700 | 11.7 | | | | |
| TGJW1150/1.0 | 1150 | 15 | 1 | 1900x1400 | 1000x2100 | 2800x2000 | 1600 | 4600 | 7.8 | 30400 | 43600 | 92000 | 75000 |
| TGJW1150/1.5 | | | 1.5 | | | | 1700 | 4700 | 11.7 | | | | |
| TGJW1150/1.75 | | | 1.75 | | | | 1700 | 4700 | 13.6 | | | | |
| TGJW1250/1.0 | 1250 | 16 | 1 | 1900x1500 | 1100x2100 | 2900x2000 | 1600 | 4600 | 8.5 | 32200 | 46800 | 106000 | 81000 |
| TGJW1250/1.5 | | | 1.5 | | | | 1700 | 4700 | 12.7 | | | | |
| TGJW1250/1.75 | | | 1.75 | | | | 1700 | 4700 | 14.9 | | | | |
| TGJW1350/1.0 | 1350 | 18 | 1 | 1900x1600 | 1100x2100 | 2900x2400 | 1600 | 4600 | 9.2 | 37600 | 46400 | 114000 | 87000 |
| TGJW1350/1.5 | | | 1.5 | | | | 1700 | 4700 | 13.8 | | | | |
| TGJW1350/1.75 | | | 1.75 | | | | 1700 | 4700 | 16.1 | | | | |
| TGJW1600/1.0 | 1600 | 21 | 1 | 2000x1750 | 1200x2100 | 3000x2400 | 1600 | 4600 | 11 | 39600 | 56500 | 128000 | 96000 |
| TGJW1600/1.5 | | | 1.5 | | | | 1700 | 4700 | 16.6 | | | | |
| TGJW1600/1.75 | | | 1.75 | | | | 1700 | 4700 | 19.4 | | | | |

(The data is for design reference only. Regarding detailed parameters, please take technical drawing as criterion.)
Note: If specification exceeds above range, please contact FUJI Elevator Company.

Machine room-less observation elevator construction sketch(round/diamond)

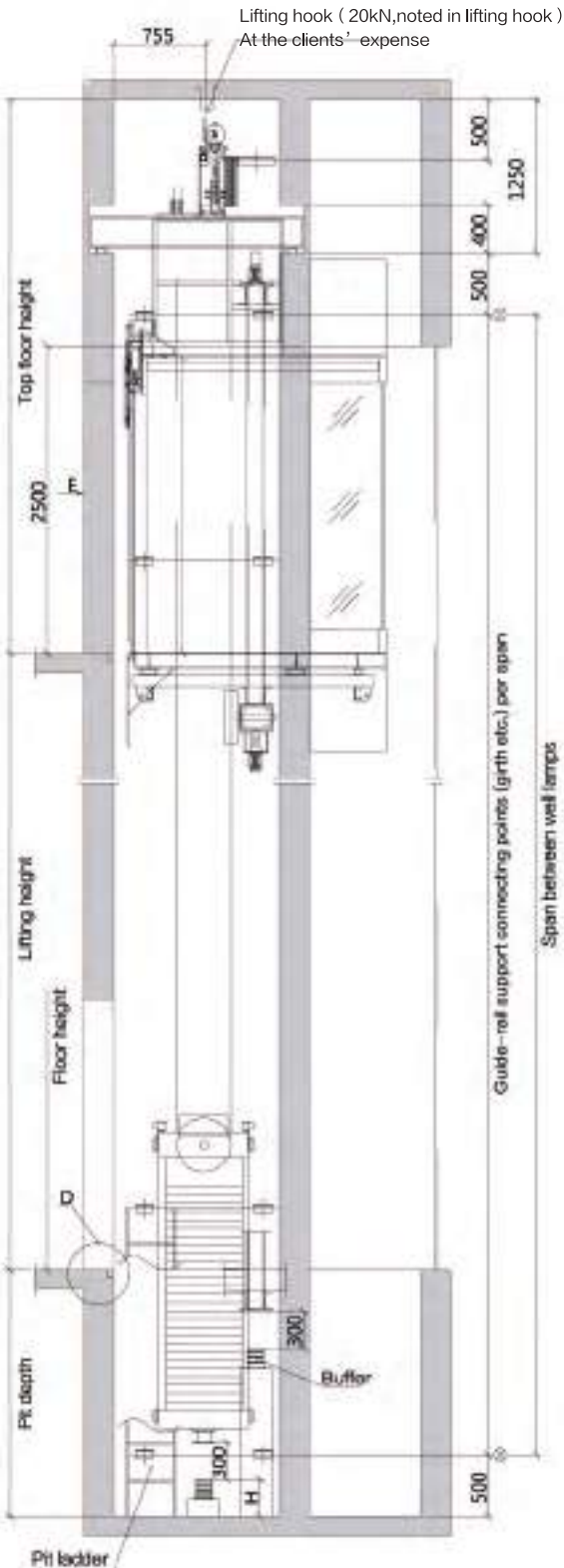

Elevator view of well right-side

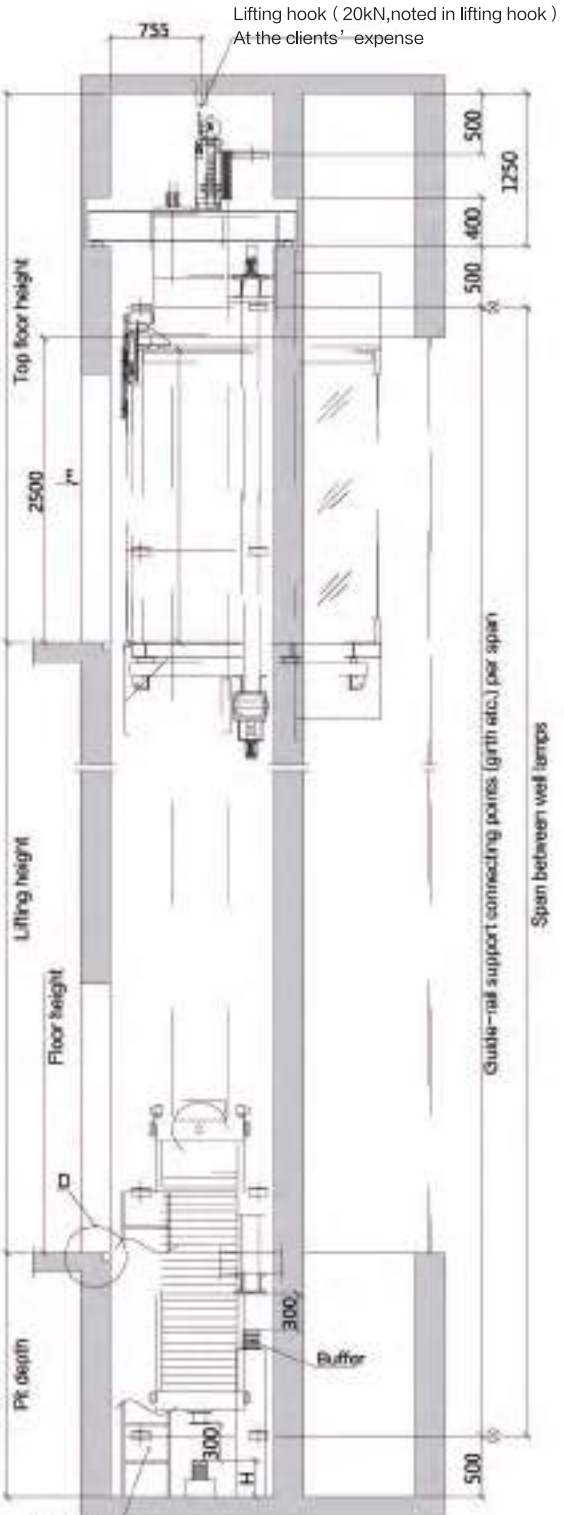

Elevator view of well right-side

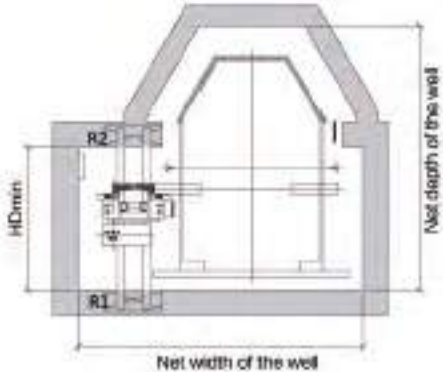

Top layout chart

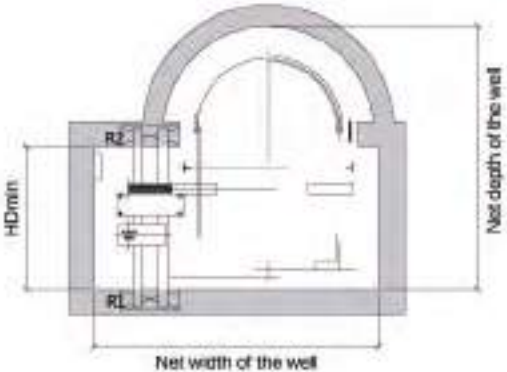

Top layout chart

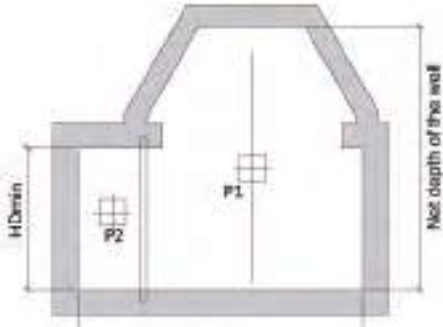

Pit layout chart

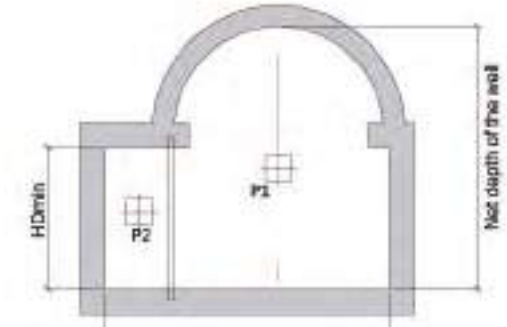

Pit layout chart

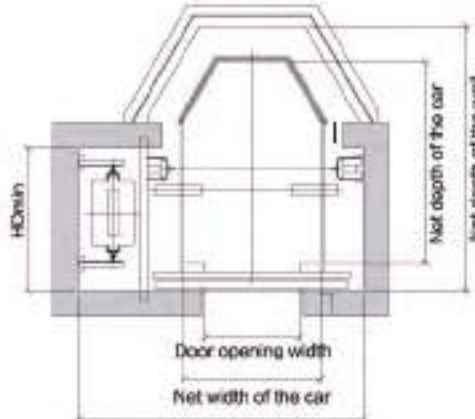

Well layout chart

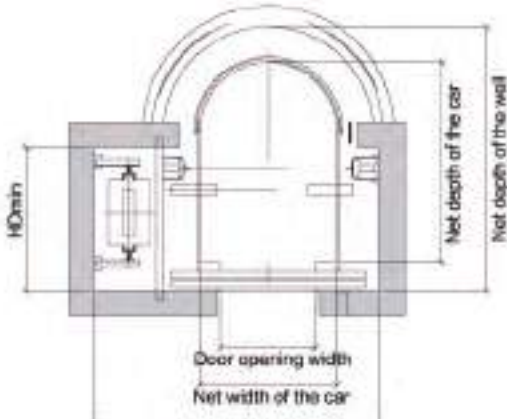

Well layout chart

| Model | Load KG | Passenger NO | speed m/s | Car specification CWxCD | Door opening size JxOPH | Well size HWxHDmin-HDmax | Pit depth Pit | Top floor height OH | Power | Acting force | | | |
|---------------|------------|-----------------|--------------|----------------------------|----------------------------|-----------------------------|------------------|------------------------|-------|--------------|-------|--------|--------|
| | | | | | | | | | | R1 | R2 | P1 | P2 |
| TG/W450/1.0 | 450 | 6 | 1 | 1000x1400 | 700x2100 | 2400x1050-2000 | 1800 | 4600 | 3.2 | 17600 | 22400 | 52000 | 41000 |
| TG/W450/1.5 | | | 1.5 | | | | 1900 | 4700 | 4.9 | | | | |
| TG/W630/1.0 | 630 | 8 | 1 | 1100x1600 | 800x2100 | 2500x1200-2200 | 1800 | 4600 | 4.3 | 21200 | 28800 | 65000 | 52000 |
| TG/W630/1.5 | | | 1.5 | | | | 1900 | 4700 | 6.4 | | | | |
| TG/W630/1.75 | 800 | 10 | 1.75 | 1200x1800 | 800x2100 | 2600x1300-2400 | 1800 | 4600 | 7.5 | 25200 | 35200 | 80000 | 64000 |
| TG/W800/1.0 | | | 1 | | | | 1900 | 4700 | 5.4 | | | | |
| TG/W800/1.5 | | | 1.5 | | | | 1900 | 4700 | 8.1 | | | | |
| TG/W800/1.75 | | | 1.75 | | | | 1900 | 4700 | 9.4 | | | | |
| TG/W1000/1.0 | 1000 | 13 | 1 | 1300x1900 | 900x2100 | 2700x1350-2500 | 1800 | 4600 | 6.7 | 29200 | 42800 | 96000 | 76000 |
| TG/W1000/1.5 | | | 1.5 | | | | 1900 | 4700 | 10 | | | | |
| TG/W1000/1.75 | | | 1.75 | | | | 1900 | 4700 | 11.7 | | | | |
| TG/W1600/1.0 | 1600 | 21 | 1 | 1700x2200 | 1100x2100 | 3100x1500-2800 | 1800 | 4600 | 11 | 36600 | 63400 | 136000 | 104000 |
| TG/W1600/1.5 | | | 1.5 | | | | 1900 | 4700 | 16.6 | | | | |
| TG/W1600/1.75 | | | 1.75 | | | | 1900 | 4800 | 19.4 | | | | |

(The data is for design reference only. Regarding detailed parameters, please take technical drawing as criterion.)
Note: If specification exceeds above range, please contact FUJI Elevator Company.

Villa elevator construction sketch

Lifting hook load-bearing 1500kg (be paid by user)
Note: Lifting hook can not be extended to top-floor net-height space.

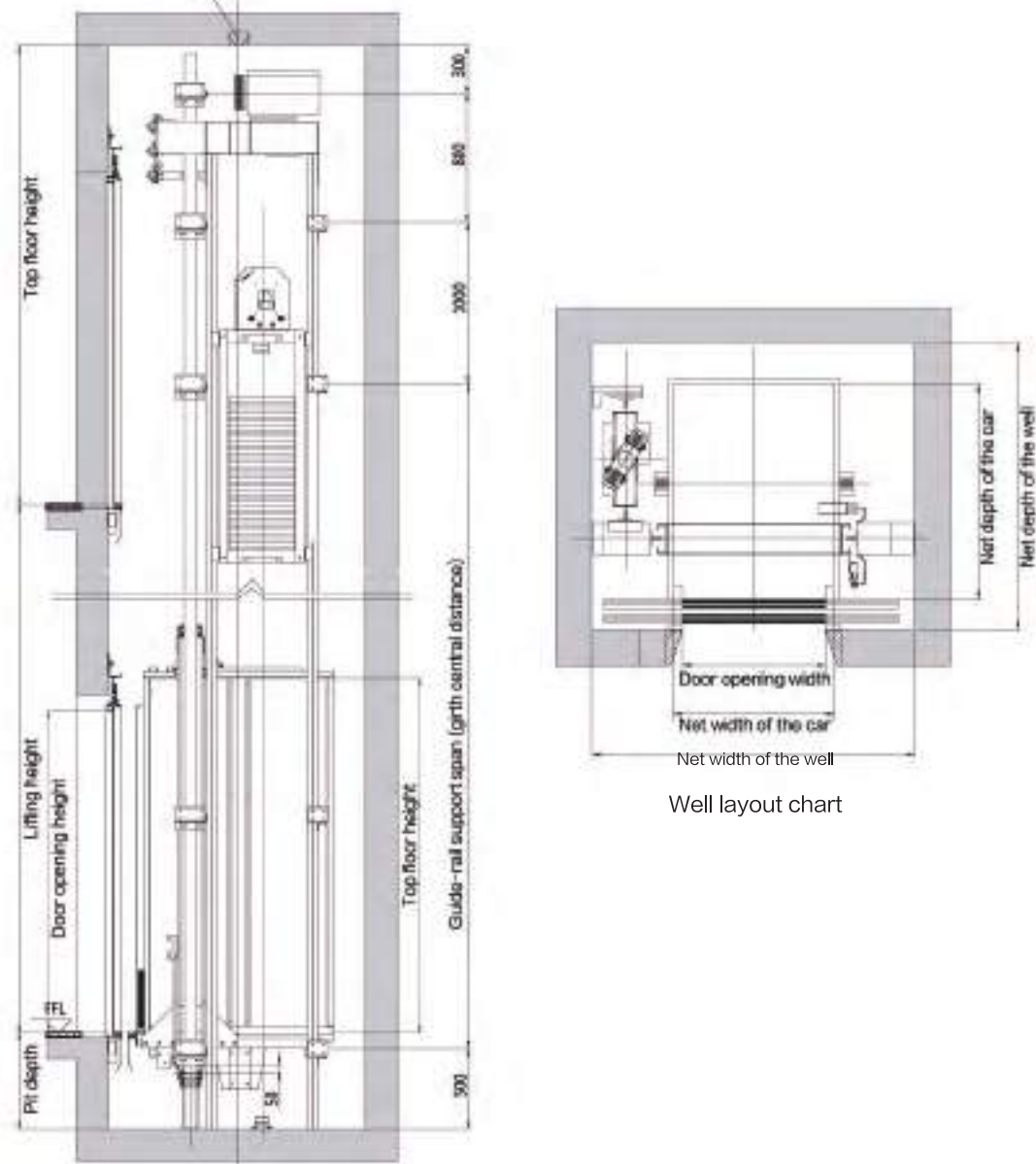

Vertical view of well side

| Model | Load KG | Passenger NO. | speed m/s | Car specification CWxCD | Door opening size JJxOPH | Well size HWxHD | Pit depth Pit | Top floor height OH | Power | Door opening mode |
|------------|---------|---------------|-----------|-------------------------|--------------------------|-----------------|---------------|---------------------|-------|----------------------|
| TJJ320/0.4 | 320 | 4 | 0.4 | 900×1150 | 800×2000 | 1800×1500 | 500 | 3100 | 0.9 | 中分 Center opening |
| TJJ400/0.4 | 400 | 5 | | 900×1200 | | 1800×1600 | | | 1.1 | |
| TJJ320/0.4 | 320 | 4 | | 900×1150 | | 1600×1500 | | | 0.9 | 旁开 Side opening |
| TJJ400/0.4 | 400 | 5 | | 900×1200 | | 1600×1600 | | | 1.1 | |

(The data is for design reference only. Regarding detailed parameters, please take technical drawing as criterion.)
Note: If specification exceeds above range, please contact FUJII Elevator Company.

Freight elevator construction sketch

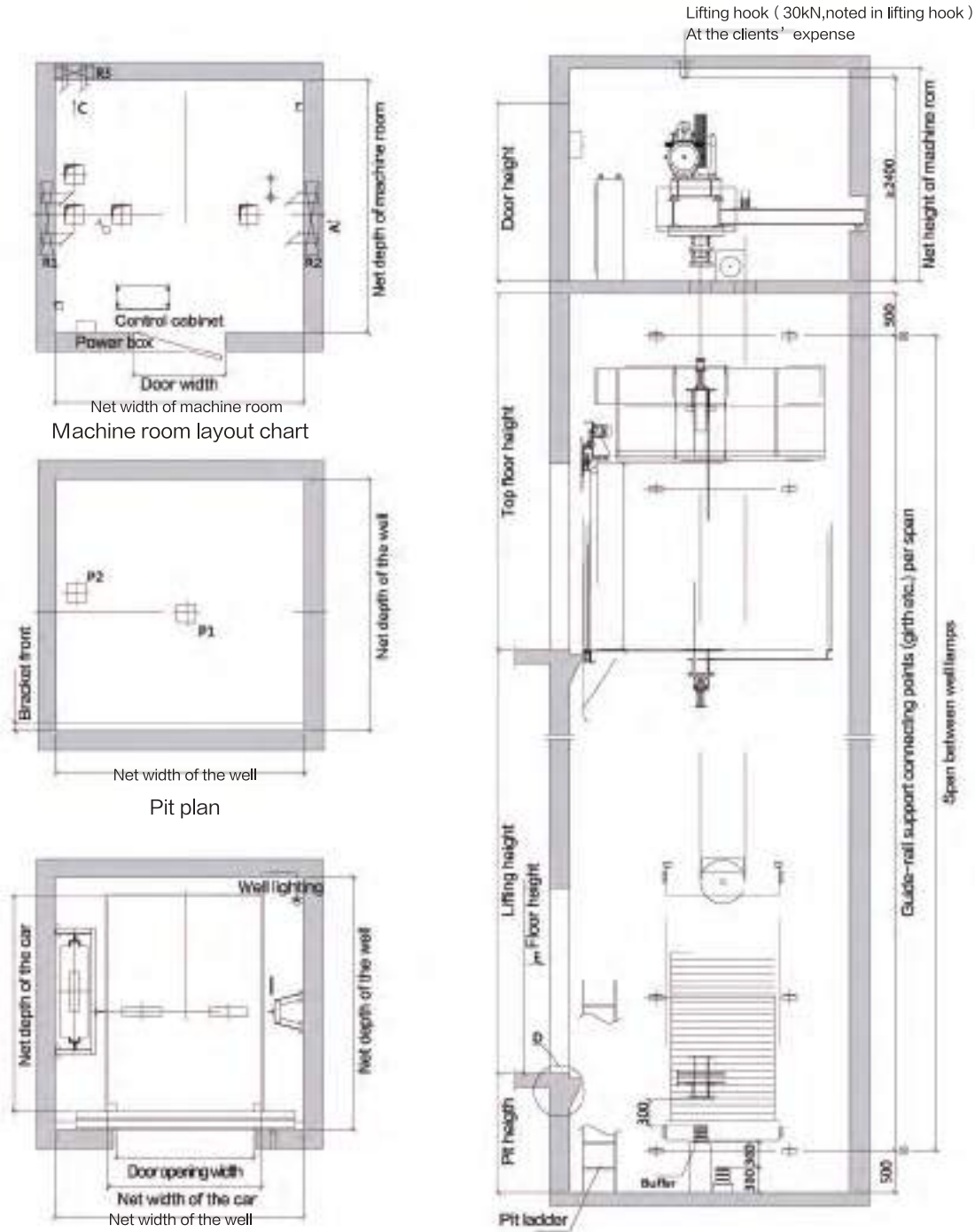

Well layout chart

Elevator view of well right-side

| Model | Load KG | speed m/s | Car specification CWxCD | Door opening size JJxOPH | Well size HWxHD | Machine room size MRWxMRD | Pit depth Pit | Top floor height OH | Power | Acting force | | | | |
|-------------|---------|-----------|-------------------------|--------------------------|-----------------|---------------------------|---------------|---------------------|-------|--------------|--------|-------|--------|--------|
| | | | | | | | | | | R1 | R2 | R3 | P1 | P2 |
| THJ1000/0.5 | 1000 | 0.5 | 1400x1700 | 1200x2100 | 2200×2200 | 2500×2500 | 1500 | 4200 | 7.5 | 54600 | 47800 | 7400 | 88000 | 68000 |
| THJ1600/0.5 | 1600 | 0.5 | 1500x2300 | 1400x2100 | 2500×2800 | 2500×2800 | 1500 | 4200 | 11 | 67600 | 58200 | 7400 | 124000 | 92000 |
| THJ2000/0.5 | 2000 | 0.5 | 1800x2300 | 1500x2100 | 2800×2800 | 2800×2800 | 1500 | 4200 | 11 | 85600 | 55200 | 8400 | 144000 | 104000 |
| THJ3000/0.5 | 3000 | 0.5 | 2000x2800 | 1800x2100 | 3450×3500 | 3250×3300 | 1500 | 4200 | 15 | 144800 | 75200 | 12000 | 224000 | 164000 |
| THJ4000/0.5 | 4000 | 0.5 | 2200x3300 | 2200x2300 | 3700×3800 | 3700×3800 | 1500 | 5000 | 18.5 | 190000 | 105200 | 16400 | 148000 | 108000 |
| THJ5000/0.5 | 5000 | 0.5 | 2400x3600 | 2200x2300 | 3800×4100 | 3800×4100 | 1500 | 5000 | 22 | 213800 | 117200 | 18200 | 172000 | 122000 |

(The data is for design reference only. Regarding detailed parameters, please take technical drawing as criterion.)
Note: If specification exceeds above range, please contact FUJII Elevator Company.

Machine room-less freight elevator construction sketch

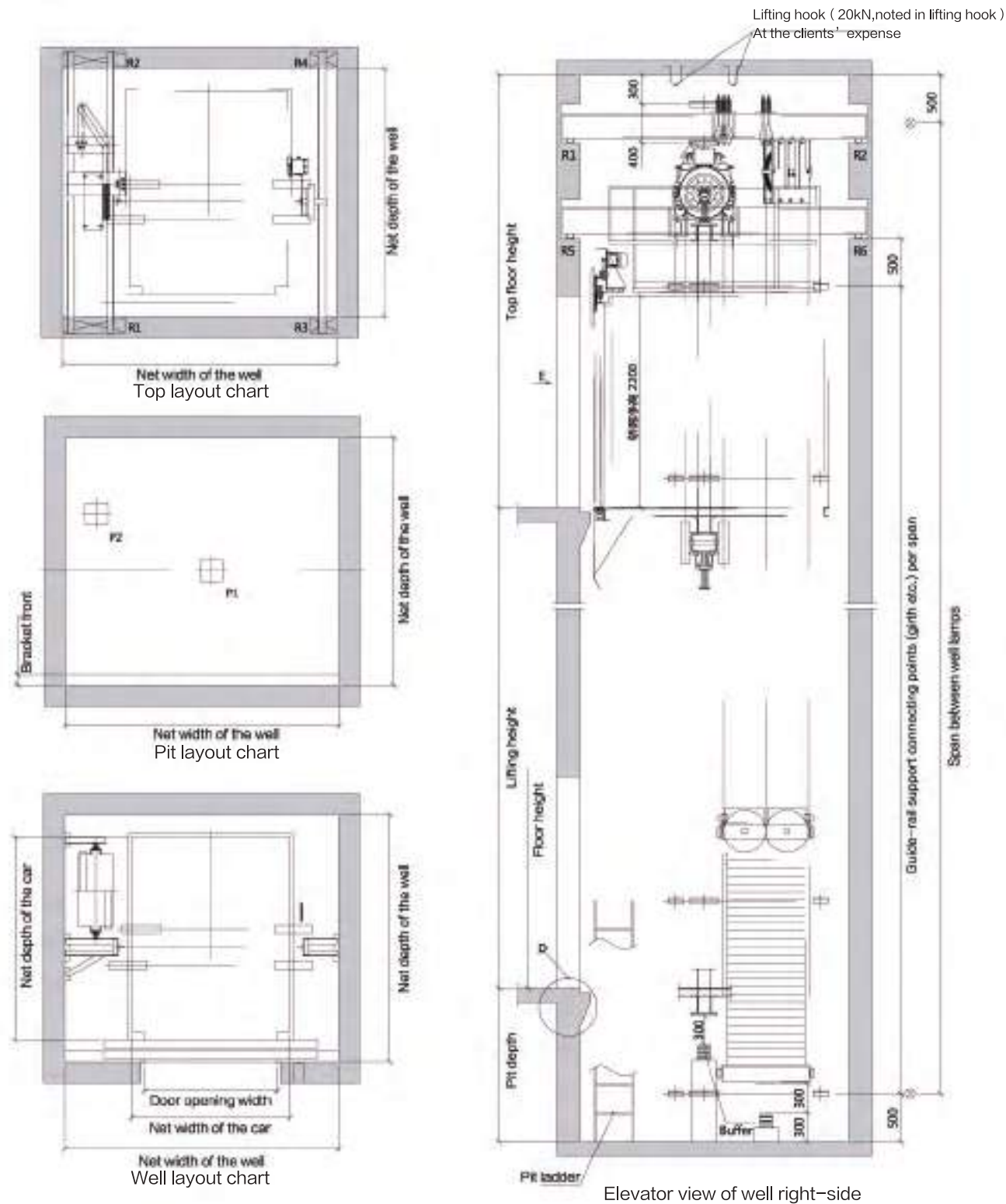

| Model | Load KG | speed m/s | Car specification CWxCD | Door opening size JjxOPH | Well size HWxHD | Pit depth Pit | Top floor height OH | Power | Acting force | | | | | | | |
|--------------|------------|--------------|----------------------------|-----------------------------|--------------------|------------------|------------------------|-------|--------------|--------|-------|-------|-------|-------|--------|--------|
| | | | | | | | | | R1 | R2 | R3 | R4 | R5 | R6 | P1 | P2 |
| THJW1600/0.5 | 1600 | 0.5 | 1800x1900 | 1500x2100 | 3100x2400 | 1600 | 4500 | 5.5 | 40400 | 73600 | 29000 | 29000 | 22600 | 19400 | 124000 | 92000 |
| THJW2000/0.5 | 2000 | 0.5 | 1800x2300 | 1500x2100 | 3100x2800 | 1600 | 4500 | 6.7 | 40400 | 73600 | 29000 | 29000 | 22600 | 19400 | 144000 | 104000 |
| THJW3000/0.5 | 3000 | 0.5 | 2000x2800 | 1800x2100 | 3450x3500 | 1600 | 4500 | 10 | 60600 | 110400 | 43500 | 43500 | 33900 | 29100 | 224000 | 164000 |

(The data is for design reference only. Regarding detailed parameters, please take technical drawing as criterion.)
Note: If specification exceeds above range, please contact FUJI Elevator Company.

30°escalator construction sketch

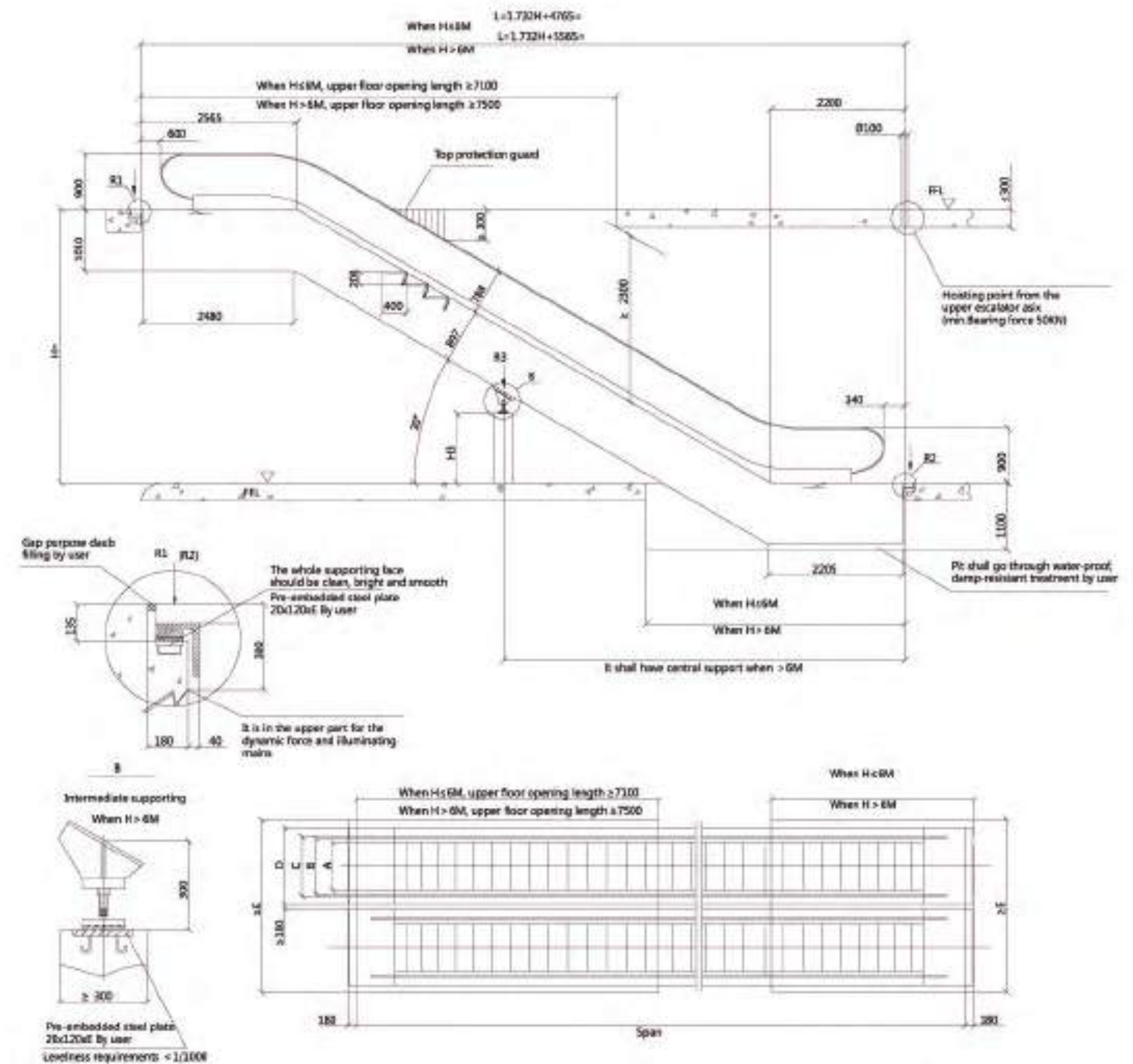

| Model | Travelling height(mm) | Net weight (KN) | Supporting | | Motor power KW | Transport size | |
|--|-----------------------|-----------------|------------|-------|----------------|----------------|-------|
| | | | R1 KN | R2 KN | | h | l |
| VF800/0.5-30° (4800/h) speed : 0.5m/s | 3000 | 118 | 104 | 94 | 5.5 | 2750 | 10900 |
| | 3500 | 126 | 112 | 100 | | 2780 | 11890 |
| | 4000 | 134 | 120 | 108 | | 2810 | 12880 |
| | 4500 | 142 | 128 | 114 | 8 | 2830 | 13870 |
| | 5000 | 148 | 136 | 120 | | 2840 | 14860 |
| | 5500 | 164 | 148 | 132 | | 2860 | 15860 |
| VF1000/0.5-30° (6000/h) speed : 0.5m/s | 6000 | 172 | 156 | 138 | 11 | 2870 | 16850 |
| | 3000 | 126 | 118 | 106 | 5.5 | 2750 | 10900 |
| | 3500 | 134 | 128 | 114 | | 2780 | 11890 |
| | 4000 | 142 | 136 | 122 | | 2810 | 12880 |
| | 4500 | 150 | 146 | 130 | 8 | 2830 | 13870 |
| | 5000 | 166 | 158 | 142 | | 2840 | 14860 |
| | 5500 | 174 | 168 | 150 | 11 | 2860 | 15860 |
| | 6000 | 184 | 176 | 158 | | 2870 | 16850 |

| | | | | | |
|-------------------------|------|---|------|------|------|
| 1000 | 1000 | 1228 | 1238 | 1600 | 3400 |
| 800 | 800 | 1028 | 1038 | 1400 | 3000 |
| step width | A | B | C | D | E |
| Intermediate supporting | | $(L/2-2600) \times \tan 30^\circ - (897/\cos 30^\circ + 300)$ | | | |

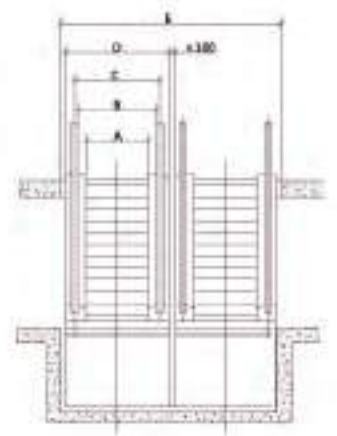

35°escalator construction sketch

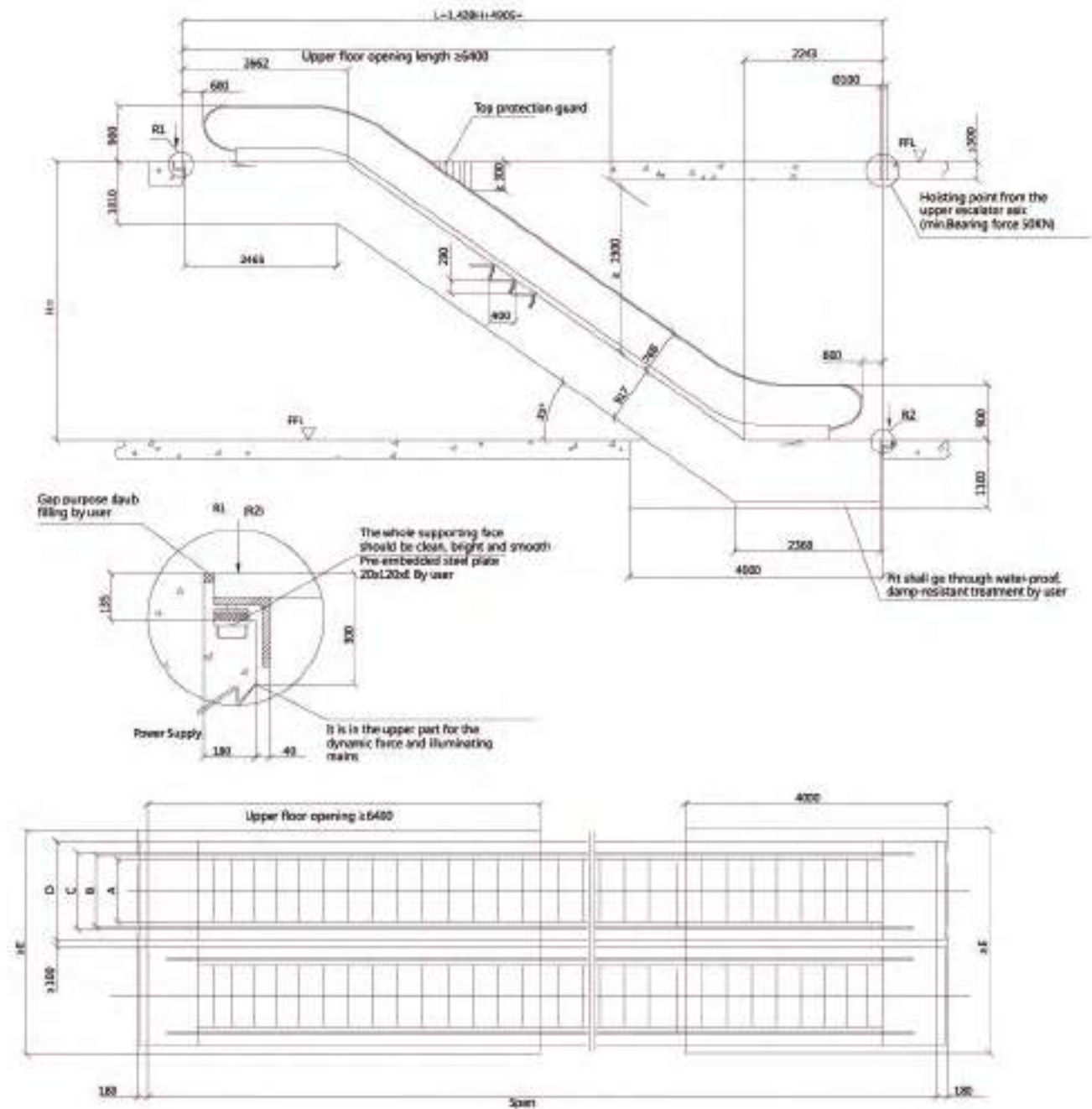

| Model | Travelling height(mm) | Net weight (KN) | supporting | | Motor power KW | Transport size | |
|--------------------------------|-----------------------|-----------------|------------|-------|----------------|----------------|-------|
| | | | R1 KN | R2 KN | | h | l |
| VF800/0.5-35° (4800/h) | 3000 | 112 | 98 | 88 | 5.5 | 2850 | 10180 |
| | 3500 | 120 | 104 | 94 | | 2890 | 11030 |
| | 4000 | 126 | 112 | 100 | | 2920 | 11890 |
| | 4500 | 132 | 118 | 106 | | 2940 | 12750 |
| | 5000 | 140 | 124 | 112 | 8 | 2970 | 13610 |
| speed : 0.5m/s | 5500 | 146 | 130 | 118 | | 2980 | 14470 |
| | 6000 | 152 | 138 | 122 | 11 | 3000 | 15330 |
| VF1000/0.5-35° (6000/h) | 3000 | 120 | 112 | 100 | 5.5 | 2850 | 10180 |
| | 3500 | 128 | 120 | 106 | | 2890 | 11030 |
| | 4000 | 134 | 128 | 114 | | 2920 | 11890 |
| | 4500 | 142 | 134 | 120 | | 2940 | 12750 |
| | 5000 | 148 | 142 | 128 | 8 | 2970 | 13610 |
| speed : 0.5m/s | 5500 | 158 | 154 | 138 | | 2980 | 14470 |
| | 6000 | 166 | 162 | 144 | 11 | 3000 | 15330 |

| | | | | | |
|------------|------|------|------|------|------|
| 1000 | 1000 | 1228 | 1238 | 1600 | 3400 |
| 800 | 800 | 1028 | 1038 | 1400 | 3000 |
| step width | A | B | C | D | E |

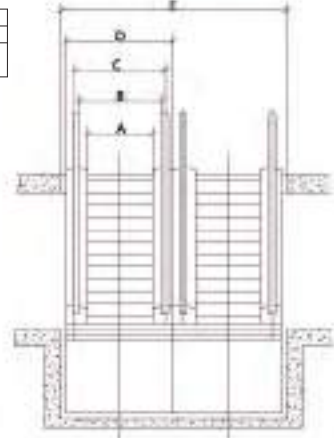

12°moving walk construction sketch

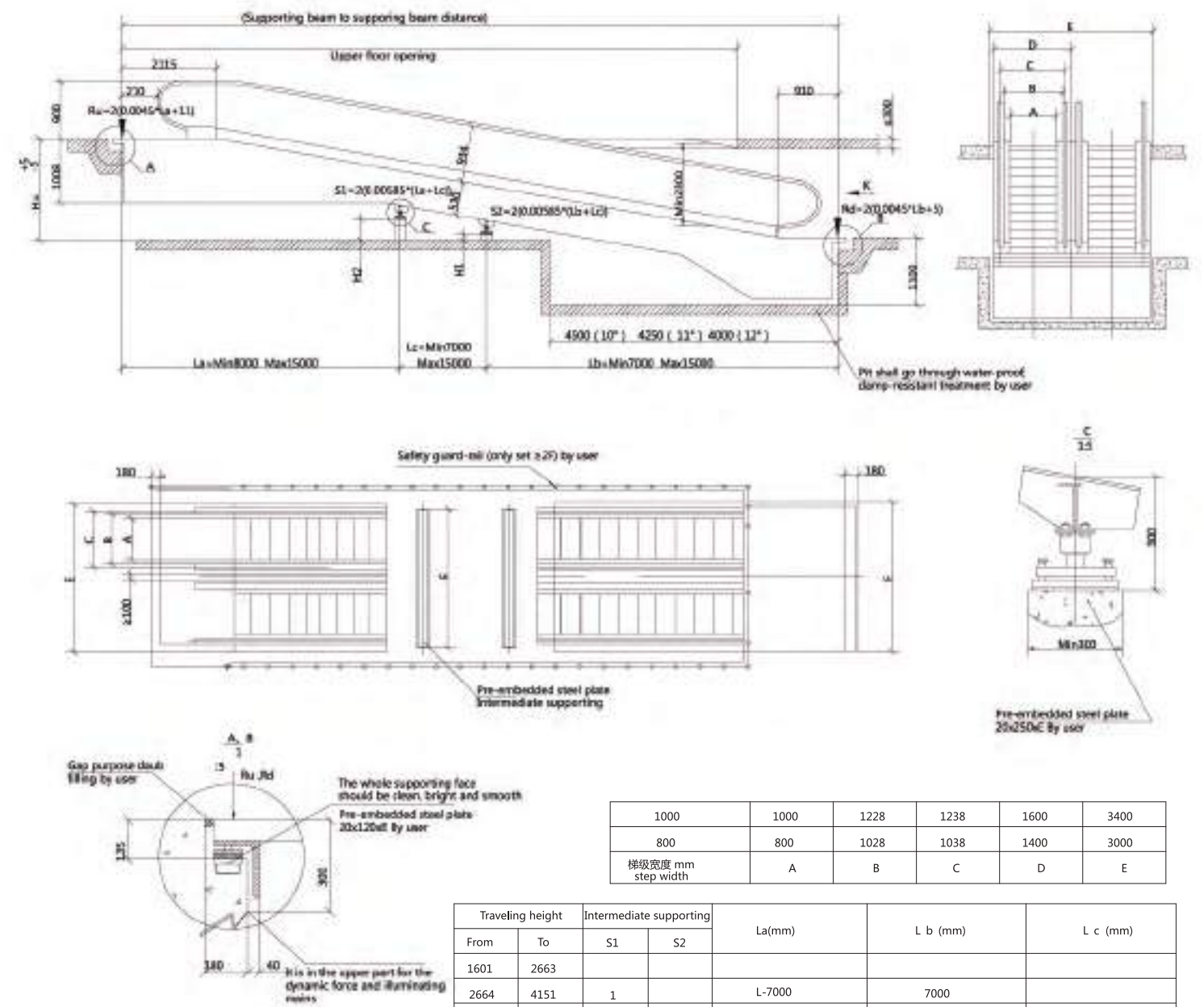

| | | | | | |
|-----------------------|------|------|------|------|------|
| 1000 | 1000 | 1228 | 1238 | 1600 | 3400 |
| 800 | 800 | 1028 | 1038 | 1400 | 3000 |
| 梯级宽度 mm step width | A | B | C | D | E |

| Traveling height | | Intermediate supporting | | La(mm) | L b (mm) | L c (mm) |
|--|--|-------------------------|----|--------|--------------------------------|----------|
| From | To | S1 | S2 | | | |
| 1601 | 2663 | | | | | |
| 2664 | 4151 | 1 | | L-7000 | 7000 | |
| 4152 | 5851 | 1 | | 15000 | L-15000 | |
| 5852 | 6000 | 1 | 1 | 15000 | 7000 | L-22000 |
| A | H2 | | | | H1 | |
| 10° | $H2 = H - (La - 1995) \times 0.1763 - 840$ | | | | $H1 = H2 - (Lc \times 0.1763)$ | |
| 11° | $H2 = H - (La - 2055) \times 0.1944 - 840$ | | | | $H1 = H2 - (Lc \times 0.1944)$ | |
| 12° | $H2 = H - (La - 2115) \times 0.2126 - 840$ | | | | $H1 = H2 - (Lc \times 0.2126)$ | |
| Note: when traveling height is over 6m, construction size please consult our company | | | | | | |

| step width | Traveling height | Speed | Rated load capacity | Inclination | Power | Power supply capacity | Rated current |
|------------|------------------|-------|---------------------|-------------|-------|-----------------------|---------------|
| 800 | 1000-3800 | 0.5 | 4800 | 10,11,12 | 7,5 | 15 | 39 |
| | 3800-6000 | | | | 11 | 22 | 58 |
| 1000 | 1000-3000 | 0.5 | 6000 | 10,11,12 | 7.5 | 15 | 39 |
| | 3000-4800 | | | | 11 | 22 | 58 |
| | 4800-6000 | | | | 15 | 30 | 78 |

All-round after-sale service



It shows repair and maintenance valueproduces the considerate service

FUJI Elevator, with its first- -class technology, rich management experience and excellent service, enjoys scientific maintenance and strict quality control of its products. We have won wide praise from customers at home and abroad for its stable quality and super high cost performance. Our service outlets have advanced logistics systems all over the country, which can fully guarantee customers'demand for delivery at any time and provide high-quality clothing. Business, early-sub-service, more care.



Professional teams



Prompt & convenient services



Service hot-line



Professional repair & maintenance



7*24-hour safeguard

FUJI elevator adopts a housekeeper service standard to ensure that customers can conduct after- sales consultation within 24 hours at any time, and professional . customer service personnel will help customers solve problems for the first time.



Modular installation

Factory modular production, saving installation labor and time costs.
Minimal installation difficulty, minimal assembly errors.



Export directly to the site

Shipping and customs clearance agents in hundreds of countries, tell us where your elevator needs to be installed, provide one-stop service.